



TAUT7 Auto-Trail 620G Excel Range Motorhomes 2023>

Item	Qty	Description	Item	Qty	Description
A	1	TAUT7 Crossbar	H	2	M16 x 50 Bolts & Nyloc Nuts
B	2	Side Arms	J	2	M12 x 40 Bolts & Nyloc Nuts
C	4	22 mm O/D 44 mm Long Spacer Tubes	K	1	M12 x 120 Bolt (10.9) & Nyloc Nut
E	2	Chassis Spacer Plates	L	2	M10 x 35 Bolts & Nyloc Nuts
F	1	Extension	M	4	M12 x 45 Bolts & Nyloc Nuts
S	1	ASP5	N	10	M12 x 90 Bolts & Nyloc Nuts
T	1	ATT—T1	P	6	10 x 25 Flat Washers
X1	N/A	OEM Chassis Angle Bracket	Q	32	12 x 25 Flat Washers
X2	N/A	OEM Chassis Floor Support	T1	1	30 mm O/D 60 mm Long Spacer Tube

Notes:

- Items **X1** coloured in **PURPLE**:- Will be temporarily removed then reinstalled on the outside of the new components.
- Items **X1** and **X2** coloured in **GREEN**:- Although some fixings are removed during the pre-installation steps they are to remain in position.

Towbar Installation:

- Remove the four fixings at the rearmost mounting points and the two vertical fixings in **X1** with reference to the Notes above.
- Loosely attach items **B** with item **X1** to the inside face of each chassis, with items **E** as spacers at the rearmost mounting points and fix in place using items **N** with items **Q** with items **C** inserted into the chassis extensions.
- Loosely attach items **X1** to items **X2** using items **L** and items **P**. **Note:** Item **P** shown in **CYAN** is also used as a spacer between items **X1** and items **X2**.
- Using items **M** with items **Q** loosely fix item **A** to items **B** to the position shown in **Figure 1**.
- Using items **J** with items **Q** and item **K** with items **Q** fix item **F** to item **A** to the position shown in **Figure 1**, ensuring item **T1** is fitted at the lower point.
- Using item **H** fix item **S** and **T** to item **F** then fully tighten all fixings ensuring the Towbar is rigid, square, and secure.

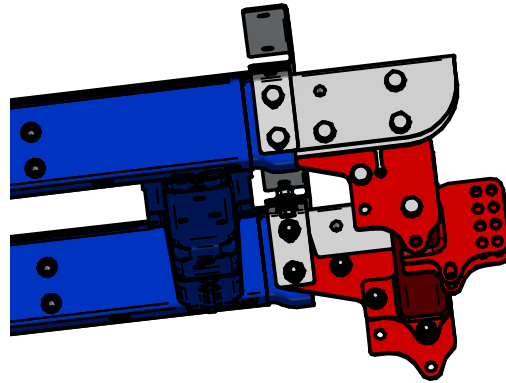
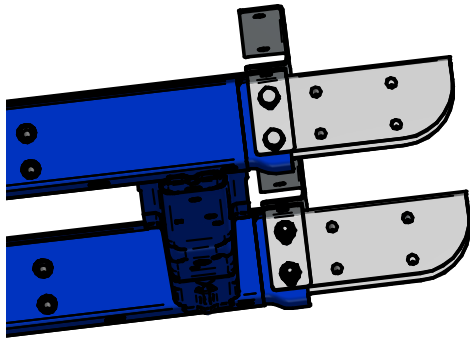
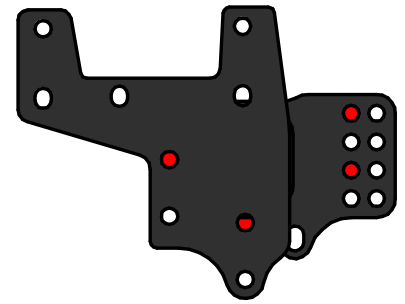
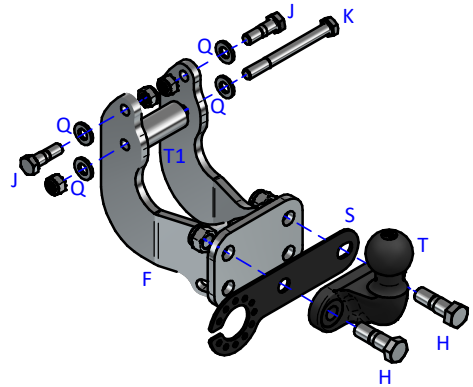
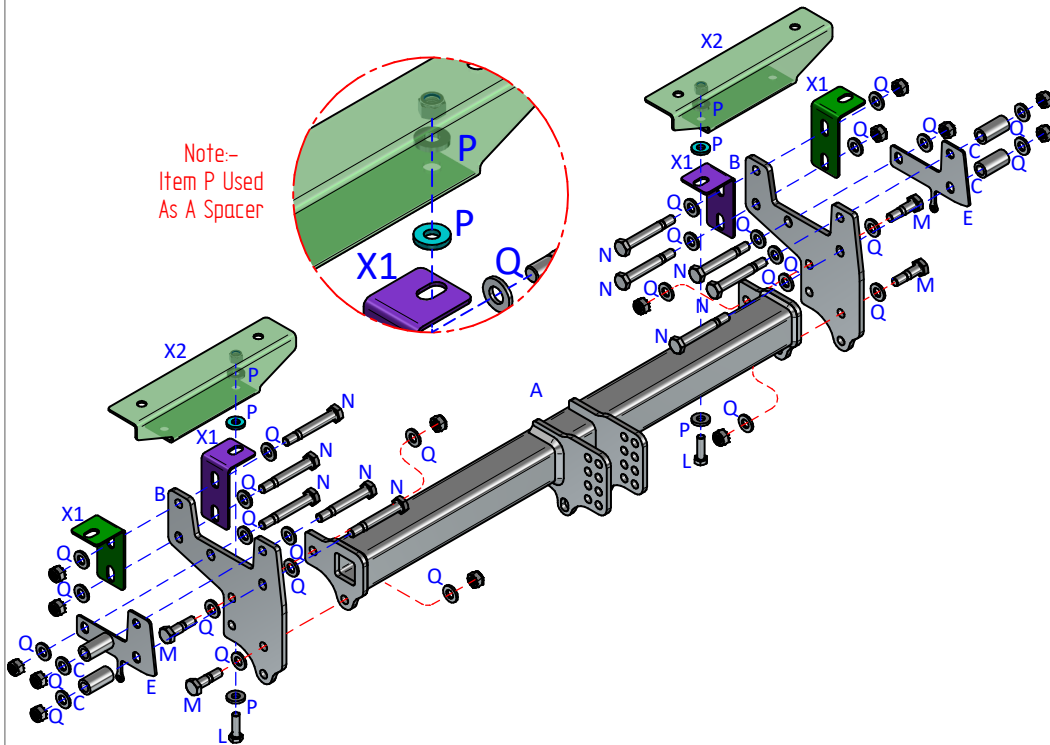

Figure 1



Note:-
Item P Used
As A Spacer



Notes:

- For Torque settings see general notes overleaf.
- Nose load limits and vehicle manufacturer's trailer / caravan weight limits must be observed.
- We recommend the use of PRO-TOW Couplings with all our products.