

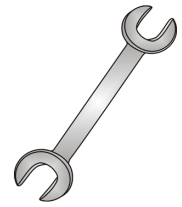

Tow-Trust Towbars

Important: Please read General Notes overleaf before fitting



Issue 3

TBM912VK BMW 1 Series 2004 - 2011

| Item | Qty | Description | Item | Qty | Description |
|------|-----|--------------------|------|-----|------------------------------|
| A | 1 | Towbar | C | 2 | M12 x 25 Bolts & S/P Washers |
| B | 1 | Detachable housing | D | 2 | M12 x 22 Bolts & S/P Washers |
| | | | E | 4 | 12 x 25 Flat Washers |
| | | | F | 1 | Flip Up Socket Plate |

1. Remove lower part of bumper. Six fixings along lower edge, three fixings around each wheel arch. Carefully prise lower section from upper part of bumper starting at each end.
2. Remove upper part of bumper. Two fixings around each wheel arch and four fixings securing bumper to bumper beam. Disconnect reversing sensors (if fitted). Pull bumper outwards at each tip, then rearwards.
3. Remove exhaust from rearmost hangers.
4. Remove bumper beam (Note: this is not refitted with the towbar) and retain all original fixings. Remove the four bumper captive nut plate fixings; these will be refitted onto new points on the Towbar.
5. On some models remove the bracket from the rear panel shown in FIG.1. (Use 8mm drill bit and through spot weld only. **(7 spot welds)**)
6. Using original fixings bolt and fully tighten Item **A** to the rear panel.
7. Using Item **C** with Item **E** and Item **D** with Item **E** bolt Item **B** and Item **F** to Item **A** and fully tighten.
8. Refit exhaust rubbers to new hangers located on the towbar.
9. Locate original captive nut plates onto new points on the towbar.
10. Replace upper part of bumper with all original fixings.
11. Cut a section centrally from under tray SEE SKETCH, if required trim to suit.
12. Replace lower part of bumper.

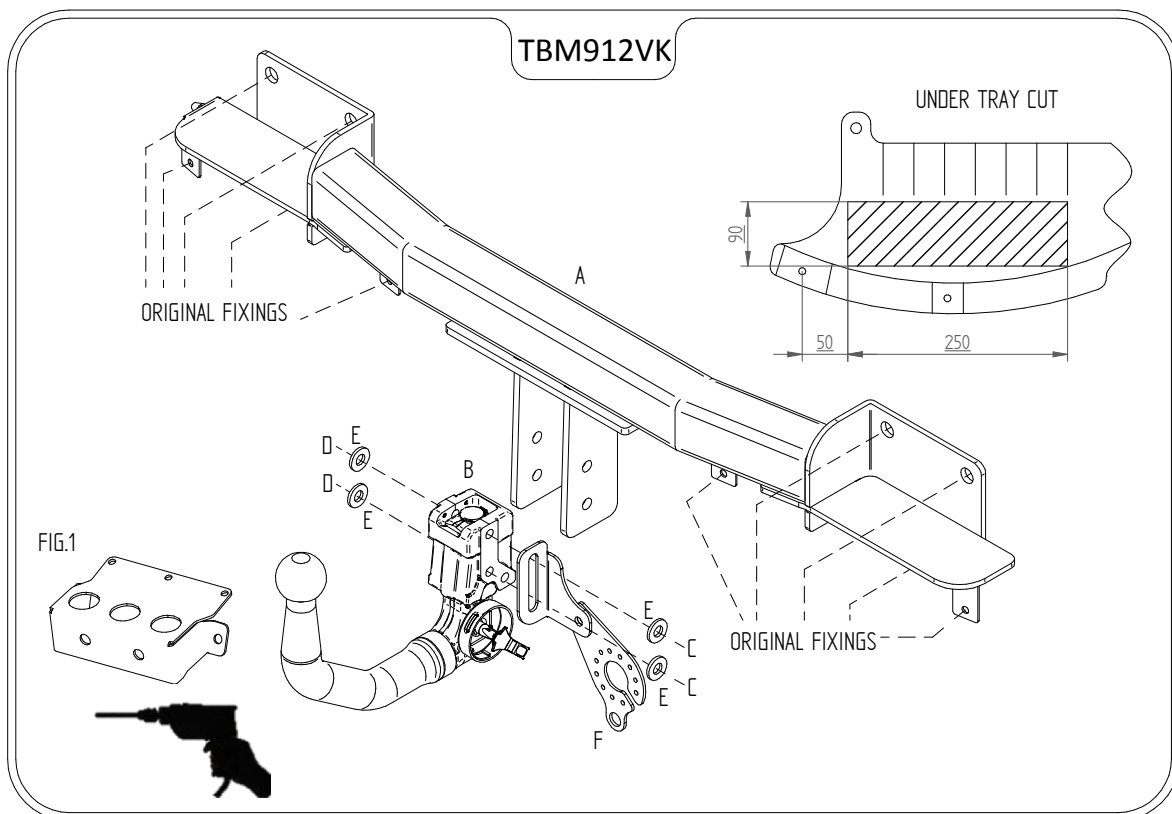

Note:

1. Recommended Torque Setting for M12 Grade 10.9 -139 Nm. (For other Torque Settings see notes overleaf.)
2. Nose load limits and vehicle manufacturers' trailer / caravan weight limits must be observed.