

TAD10 Type GH/GF Audi Q6 e-tron/ Q6 e-tron Sportback 2024>, Type XA Porsche Macan-e 2024>

Item	Qty	Description	Item	Qty	Description	Torque Setting
A	1	TAD10 Crossbar	F	2	M16 x 50 Bolts & Nyloc Nuts	215 Nm
B1	2	Rear Panel Bracket	G	2	M12 x 35 (10.9) Serrated Flange Bolts & Serrated Flange Nuts	130 Nm
B2	2	Rear Panel Bracket	H	1	M12 x 120 Bolt (10.9) & Serrated Flange Nut	130 Nm
C	2	Rear Panel Sealing Plate	J	3	M6 X 40 Bolts & S/P Washers	13 Nm
D	1	Macan-e Engine Speaker Plate	K	3	M8 x 50 Bolts & S/P Washers	25 Nm
E	1	Extension	L	4	M14 x 120 Bolts & Nyloc Nuts	150 Nm
T1	3	15mm O/D 24mm Long Spacer Tube	M	3	6 x 15 Flat Washers	
T2	1	30 mm O/D 60 mm Long Spacer Tube	N	3	8 x 25 Flat Washers	
			Q	9	12 x 30 Belleville Spring Washers	
X	1	Macan-e Engine Speaker	R	8	14 x 27 Flat Washers	
X1	3	OEM Chassis Fixings	S	8	M12 x 1.5 Fine Pitch Nyloc Nuts	130 Nm

Note: Some fitters may choose to pre-assemble item A with items B1 and B2 using items M with items R then loosely fix to the rear panel.

Audi Q6 Bumper Removal

- Open the tailgate and remove each light cluster's trim panel, pushing them in towards the body to release them from the cluster's and remove. Remove the now revealed two fixings each side and fully remove the clusters.
- Remove the now revealed sliding clamp securing the bumper to the body from each side.
- Remove the central rear interior trim panel and two plastic caps situated in the interior side panels and remove the four internal bumper fixings.
- Remove the three fixings from the wheel arch area and one vertical fixing from the wheel arch trim rear of the back doors.
- Fully remove the wheel arch trim's and the remove the now revealed fixing from each side.
- Peel back the wheel arch lining and remove the three fixings from each side.
- Remove the twelve fixings along the bumpers lower edge and disconnect the wiring loom from the left-hand side of the vehicle.
- Release the bumper, pulling sideways and rearwards to remove.
- Remove the rear impact beam, four fixings each side. **Note:** The impact beam and its fixings will not be refitted with the towbar assembly.

Porsche Macan-e Bumper Removal

- Open the tailgate and remove each light cluster's trim panel, pushing them in towards the body to release them from the cluster's and remove. Remove the now revealed two fixings each side and fully remove the clusters.
- Remove the tailgate bump stop situated below the rear cluster from each side.
- Remove the number plate and remove the four now revealed fixings. **Note:** Some models may not have these fixings.
- Remove one fixing each side from the bumpers lower edge securing the wheel arch trim then three fixings from the wheel arch liner each side.
- Peel back the arch liner and remove the five fixings securing the wheel arch trim to the body and remove from each side.
- Remove the fixings securing the undertray to the bumper plus the two additional vertical fixings now revealed.
- Disconnect the bumpers wiring loom located behind the boots right-hand removable interior panel.
- Release the bumper, pulling sideways and rearwards to remove.
- Remove the rear impact beam, four fixings each side. **Note:** The impact beam and its fixings will not be refitted with the towbar assembly.
- Remove item X from to the rear panel unclipping the wiring loom from along the body to the main loom and replace the three fixings.
- Remove items X1 from the left-hand side of the underside of the vehicle shown in **Figure 1**. **Note:** These fixings will not be reused.
- Loosely fix item D to the underside of the vehicle using items K with items N and items T1 as shown in **Figure 2** and the **Figure 4** exploded diagram shown on **Page 2** and fully tighten the three fixings.
- Loosely fix item X to item D using items J and items M as shown in **Figure 3** and fully tighten. Then clip the wiring loom back into place where possible.

All Models Towbar Installation

- Loosely hang items C onto the rear panel studs each side **Note (Audi Q6 Only):** Fully seal the rear panel and chassis openings with a suitable sealant to prevent water ingress as shown in **Figure 5**.
- Loosely fix items B1 and items B2 to the rear panel using items Q with items S.
- Loosely fix item A to items B1 and items B2 using items M with items R.
- Fully tighten all the fixings ensuring the Towbar is rigid, square and secure.
- Refit the bumper and light clusters, reattaching any wiring looms.
- Loosely fix item E to item A to the position shown in **Figure 6** using items G and item H with items Q, ensuring item T2 is fitted at the lower mounting point.
- Using item F fix your desired ball bracket and wiring plate (**Not supplied in this kit**) to item E and fully tighten all the remaining fixings.

Figure 1

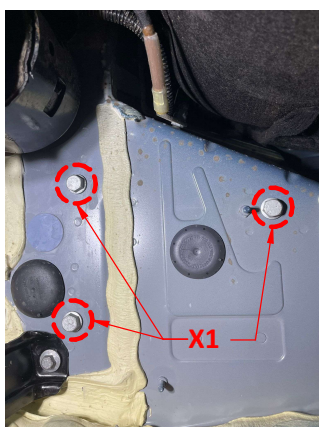

Figure 2



Figure 3

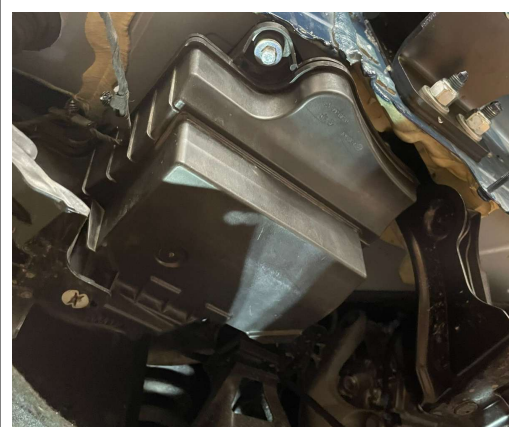

Figure 4
Porsche Macan-e Only

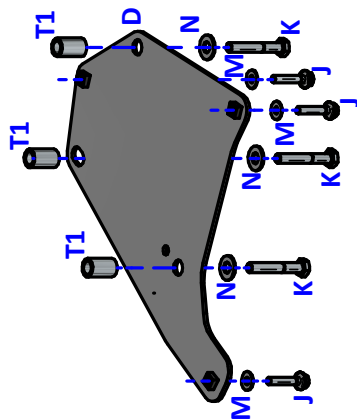

Figure 5
Audi Q6 Only

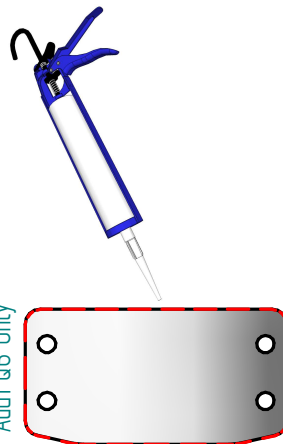
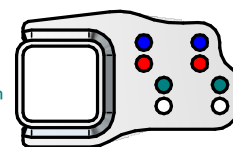
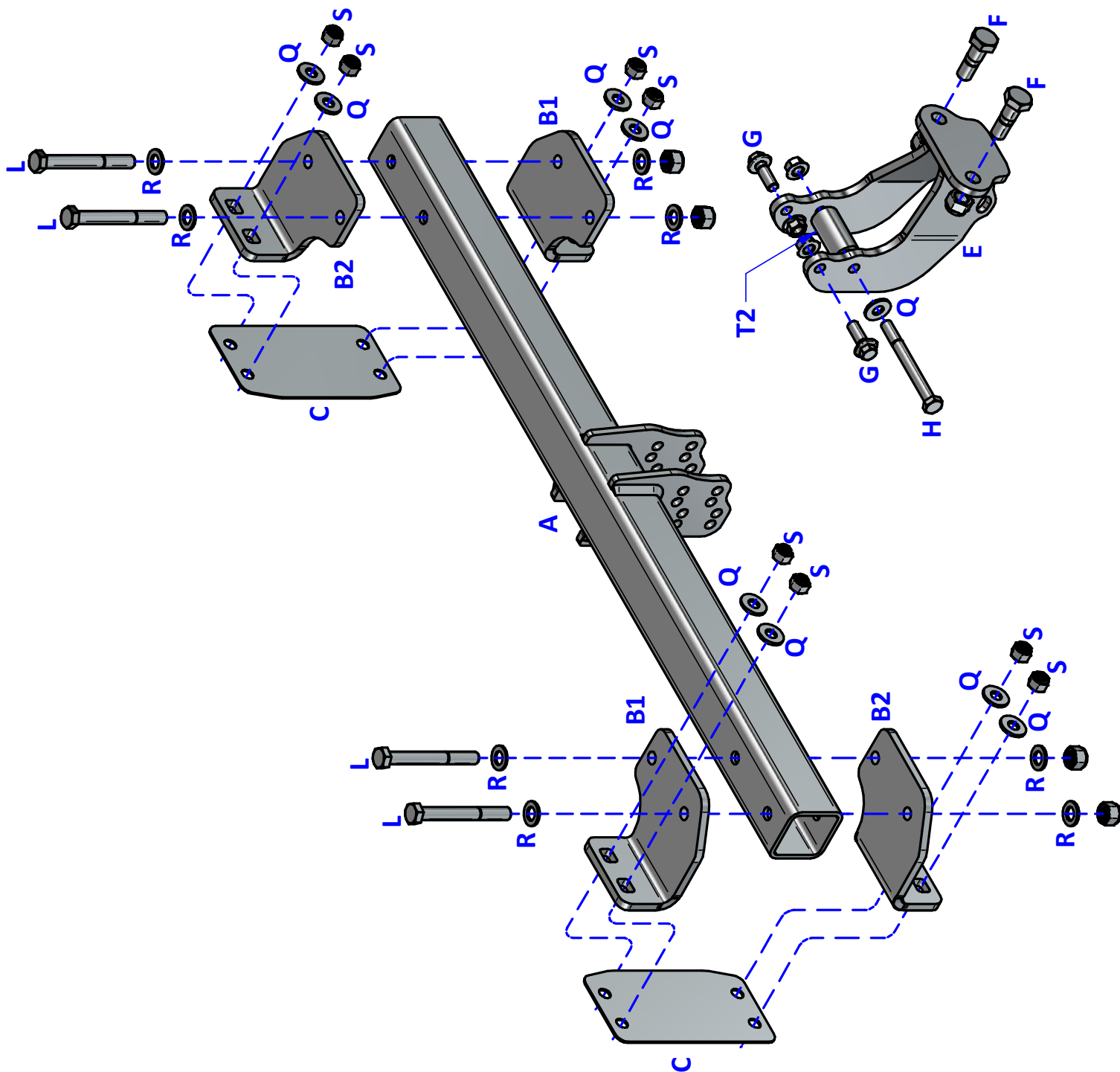

Figure 6



- Audi Q6 e-Tron
- Porsche Macan-e
- Porsche Macan-e With Bolt On Bike Rack Only



- Notes:
1. For Torque settings see the column next to each item in the list.
 2. Nose load limits and vehicle manufacturer's trailer / caravan weight limits must be observed.
 3. We recommend the use of PRO-TOW Couplings with all our products.