

TPUG17SN Peugeot 3008 Mk3 2024>, Peugeot 5008 Mk3 2024>, Vauxhall Grandland Mk2 2024>, Citroen C5 Aircross Mk2 2025> & DS8 2025>

Item	Qty	Description	Item	Qty	Description	Torque Setting
A	1	TPUG17 Crossbar	D	1	VASP8/LH Socket Plate	
B	2	Side Arms	E	2	15mm Swan Neck Spacers	
C	1	ACS8 / 9208 Swan Neck	F	2	M12 x 110 (10.9) Bolts & Nyloc Nuts	130 Nm
			G	12	M10 x 40 (10.9) Bolts & 8 S/P Washers	70 Nm
			H	2	M12 x 35 Bolts & S/P Washers	100 Nm
			J	16	10 x 25 Flat Washers	
			K	4	12 x 25 Flat Washers	
			L	2	12 x 40 Flat Washers	

Bumper Removal

1. Open the tailgate and remove the inner light cluster panels, three fixings.
2. Remove the rear inner boot panel.
3. On vehicles without a spare wheel, lift the lower boot wheel well floor trim. On vehicles with a spare wheel, remove the small covering panel on each side.
4. Remove the fixing in the boot opening securing the outer bumper panel from each side.
5. Remove the twelve fixings along the lower edge of the bumper.
6. On the underside of the bumper pivot down the small access panels located behind each of the rear wheel arches and disconnect the electrical and gsm connector on the nearside and the number plate washer feeder pipe on the offside. **Note:** There is an additional small retaining clip that must be removed on the feeder pipe.
7. Carefully release the outer wheel arch trim from each side then remove the three fixings and one clip.
8. Pull back the wheel arch trim and remove the tip screw from each side.
9. Carefully release the bumper from the rear wings and from below and around each light cluster and fully remove.
10. Cut the bumper, removing the pre marked area.
11. Remove the rear impact beam, eight fixings and lift off the location pins. **Note:** This will not be reused with the towbar assembly.

Towbar Installation

1. Loosely hang item A using the keyhole slots on the location pins each side of the rear panel and loosely fix to the rear panel using items G with items J.
2. Insert items B into each side of the chassis rail and loosely fix in place from inside the boot area using items H with items L.
3. Loosely fix items A to item B using items G and items J.
4. Loosely fix item C and item D with items E to item A using items F with items K at the position shown in **Figure 1**.
5. Fully tighten all fixings ensuring the Towbar is rigid, square and secure.
6. Remount the bumper and all trim panels then reconnect the wiring loom and feeder pipe each side respectively.

Figure 1

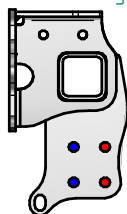

- Not Used
- All Models

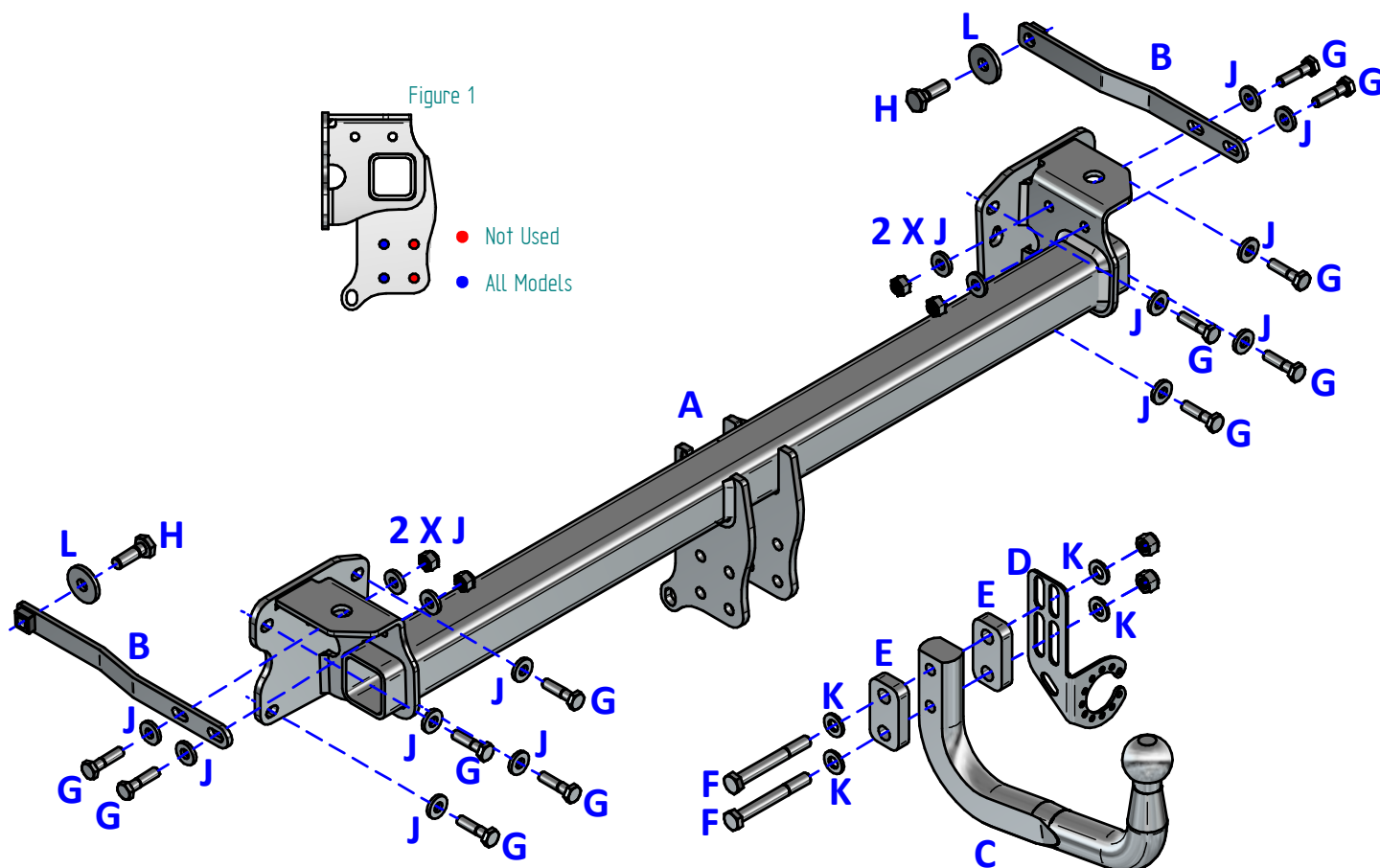

Notes:

1. For Torque settings see the column next to each item in the list.
2. Nose load limits and vehicle manufacturer's trailer / caravan weight limits must be observed.
3. We recommend the use of PRO-TOW Couplings with all our products.