



## TSY3VK Ssangyong Rexton 2017> All Models Inc. Vehicles with Underslung Space Saver and Ad Blue

Item	Qty	Description	Item	Qty	Description	Torque Setting
A	1	TSY3 Crossbar	H	3	M12 x 25 (10.9) Bolts & S/P Washers	130 Nm
B1	1	Left Hand Lower Chassis Bracket	J	3	M12 x 25 (10.9) Bolts & S/P Washers	130 Nm
B2	1	Right Hand Lower Chassis Bracket	K	2	M6 x 20 Self Tapping Bolts	13 Nm
C	2	Upper Chassis Bracket	L	2	M8 x 25 Bolts & Nyloc Nuts	25 Nm
D	2	Chassis Tube Insert	L1	1	M8 x 50 Bolt & Nyloc Nut	25 Nm
E	2	Bumper Brackets	M	4	M12 x 110 (10.9) Bolts & Nyloc Nuts	130 Nm
F	1	6#16 Detachable Neck	N	6	M12 x 160 Bolts & Nyloc Nuts	100 Nm
			P	2	6 x 15 Flat Washers	
			Q	11	8 x 25 Flat Washers	
			R	14	12 x 25 Flat Washers	
			S	12	12 x 40 Flat Washers	
G1	1	Right Hand Three Hole Flip Up Socket Plate Bracket	T	2	8 x 15 Flat Washers	
G2	1	Flip Up Socket Plate	U	1	Neoprene Washer	

### Bumper Removal:

1. Open the tailgate and remove the rear light clusters. Two fixings, followed by the now revealed bumper fixings from each side.
2. Remove the three fixings from the wheel arch trim and carefully separate the trim from the bumper and body from each side.
3. Remove the remaining three fixings from the wheel arch liner and remove the tip screw from each side.
4. Remove the six fixings along the bumpers lower edge. **Note:** The central two bolts will not be reused with the towbar assembly.
5. Unplug the wiring loom from the nearside. **Note:** Some models may have an additional cable on the offside.
6. Pull the bumper out sideways and rearwards to remove.
7. Remove the polystyrene inner bumper liner by removing the four metal clips.
8. Remove the rear impact beam. Four fixings. **Note:** The polystyrene liner, the impact beam and its fixings will not be reused with the Towbar Assembly.
9. Cut the bumper as shown in **Figure 1**.

### Towbar Installation For All Models:

1. Using **Figure 2** as a guide insert items **D** into the chassis and line up with the mounting points. **Note:** Ensure item **D** is orientated as shown in **Figure 2**.
2. Using **Figure 2** as a guide loosely fix items **B1** and **B2** onto the chassis at the forwardmost mounting points using items **N** with Items **S**.
3. Using **Figure 3** as a guide loosely fix items **B1**, **B2** and items **C** onto the chassis using items **N** with items **S**.
4. Loosely fix item **A** to items **B1**, **B2** and items **C** using items **M** with items **R**.
5. Loosely fix items **E** to item **A** using items **K** with items **P**.
6. Using **Figure 4** as a guide, loosely fix item **F** and item **G1** to item **A** using items **J** with items **R** and items **H** with items **R**.
7. Fully tighten all the fixings ensuring the Towbar is centralised, rigid, square and secure.
8. Remount the bumper, rear light clusters and reconnect the wiring loom. Replacing the central lower bumper fixings with items **L** with items **Q** and fully tighten.
9. Fix item **G2** to item **G1** using item **L1** with items **T**, item **U** and items **Q**.

**Note:** To avoid an additional bumper cut the quantity of items **Q** can be adjusted to suit the clearance required for the electrical socket.

Figure 1

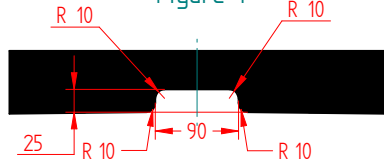

Figure 2  
(Offside Chassis Shown)

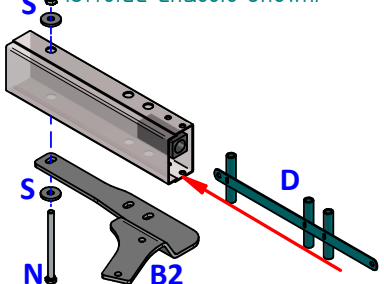

Figure 3

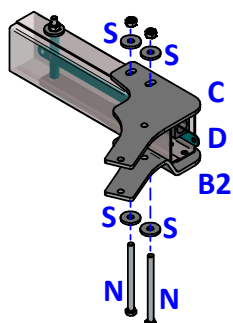
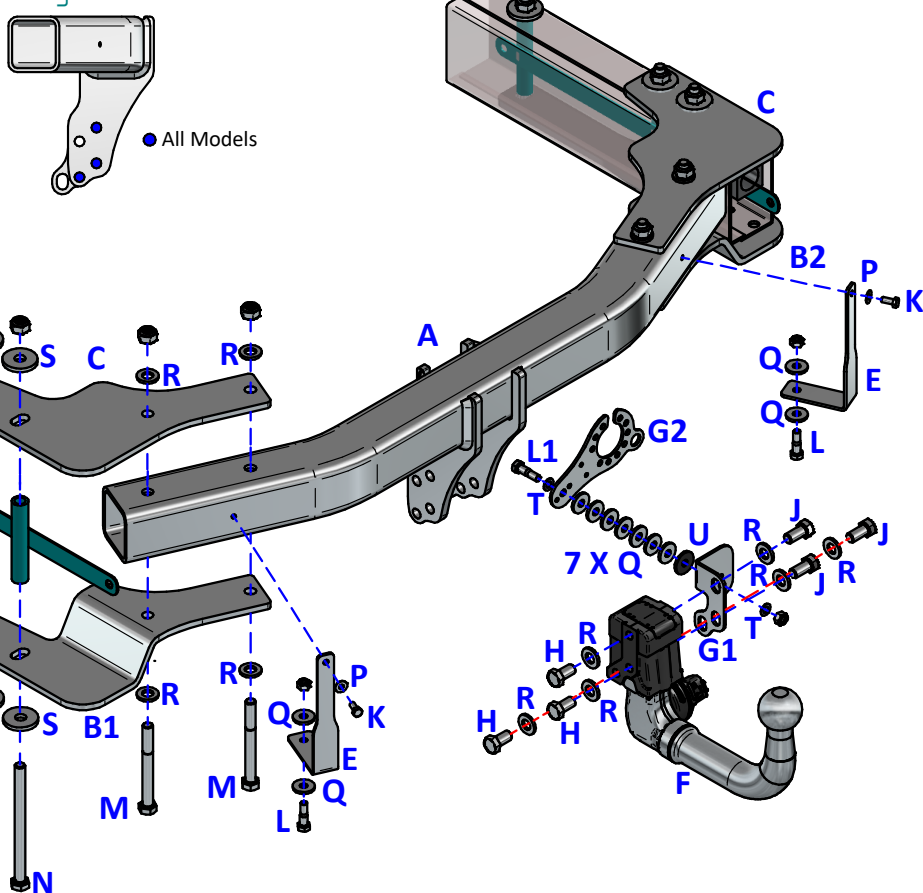

Figure 4



- Notes:**
1. For Torque settings see the column next to each item in the list.
  2. Nose load limits and vehicle manufacturer's trailer / caravan weight limits must be observed.
  3. We recommend the use of PRO-TOW Couplings with all our products.