

## TREN19VK Renault Capture (RJB) 2019>, Nissan Juke (F16) 2019>, Mitsubishi ASX 2024>, Renault Symbol (DJB) 2024>

Item	Qty	Description	Item	Qty	Description
A	1	TREN19 Crossbar	F	1	Flip Up Socket Plate (TTFP/LH)
B	2	Side Arms	G	2	M12 x 22 Bolts & S/P Washers
C	4	Chassis Spacers	H	2	M12 x 25 Bolts & S/P Washers
D1	1	Left Hand Bracket (Capture/ASX/Symbioz)	J	4	M6 x 20 Self Tapping Bolts
D2	1	Right Hand Bracket (Capture/ASX/Symbioz)	K	4	M6 x 15 Bolts & Nyloc Nuts
E	1	6#07 Detachable Neck	L	4	M12 x 45 Bolts & Nyloc Nuts
			M	4	M12 x 45 Bolts & S/P Washers
			N	12	6 x 20 Flat Washers
			P	12	12 x 25 Flat Washers
			Q	4	12 x 30 Flat Washers

### Bumper Removal (Renault Capture/Mitsubishi ASX/Renault Symbol)

1. Remove the rear light clusters one fixing each side. Then remove the two now revealed fixings from around the light cluster area from each side.
2. Remove the nine fixings along the bumpers lower edge followed by the two fixings in the wheel arch plus the clip just behind/above the wheel and the tip screw.
3. Pull the wheel arch trim away to gain access to the wheel arch trim clips, free the arch trim from the bumper/body.
4. Remove the spare wheel well cover shown in **Figure 4** from the underside six fixings, then pull the bumper out sideways and rearwards to remove, unplugging the sensor loom.
5. Drill out the rivets securing the two central internal plastic bumper brackets to the impact beam (Retain these as they will be reinstalled later) then remove the impact beam, four fixings, (This is not reused with the Towbar assembly), replace the fixings back into the panel.

### Bumper Removal (Nissan Juke)

1. Open the tailgate and remove the rear light clusters one fixing and the fixing below the cluster from each side. Then remove the two now revealed fixings from around the light cluster area.
2. Remove the eight fixings along the bumpers lower edge and the three fixings in the wheel arch.
3. Unclip the wheel arch trim and remove the tip screw from each side.
4. Pull bumper out sideways and rearwards, unplugging the sensor loom from nearside and fully remove from the vehicle.
5. Remove the impact beam six fixings replace the fixings back into the panel. **Note:** This will not be used with the Towbar assembly.
6. Remove the spare wheel well cover from the underside five fixings.
7. Remove the lower plastic trim four fixings from the rear panel and cut as shown in **Figure 2** then remount to the rear panel.

### Towbar Installation

1. Remove the tape covering the two mounting points in the chassis from each side.
2. Loosely attach items **B** to the chassis using items **M** and items **Q** with items **C**.
3. Loosely attach item **A** to items **B** using items **L** with items **P**.
4. Loosely attach items **D1** and **D2** (Capture/ASX/Symbioz) to item **A** using items **J** and items **N**.
5. Loosely attach the internal plastic bumper brackets to items **D1** and **D2** using items **K** and items **N** as shown in **Figure 1**.
6. Fully tighten all the fixings ensuring the Towbar is rigid, square, and secure.
7. Loosely attach item **E** and item **F** to item **A** using items **H** with items **P** and items **G** with items **P**.
8. Fully tighten all the fixings ensuring the Towbar is rigid, square, and secure.
9. Cut the bumper in the lower face where the pre-marked area is using **Figure 3** as a guide then remount onto the vehicle.
10. Cut the spare wheel well cover using **Figure 4** as a guide and remount onto the vehicle.

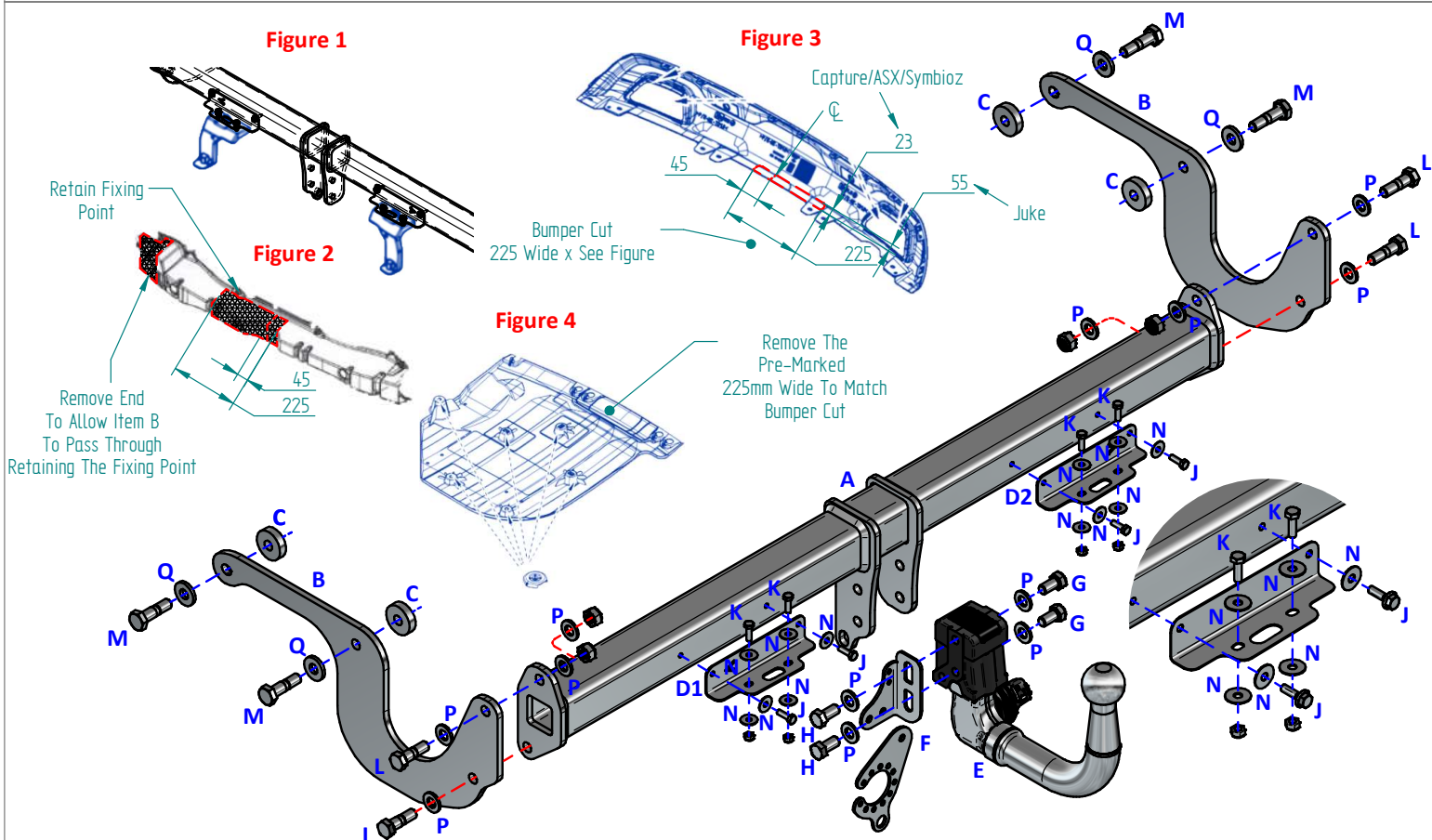

### Notes:

1. For Torque settings see general notes overleaf.
2. Nose load limits and vehicle manufacturer's trailer / caravan weight limits must be observed.
3. We recommend the use of PRO-TOW Couplings with all our products.