

**TAUT9SN-9203 Auto-Trail (Ford Based) Drop Down Floor Range Motorhomes 2024>
& Ford Based Internally Mounted Chassis Extensions With 145mm Hole Centres 814-834mm Internally Mounted
Up To 4100kg GVW With Maximum Towing Capacity 1750kg 2006>**

Item	Qty	Description	Item	Qty	Description
A	1	TAUT9 Crossbar	H	1	VASP8/RH
B	2	Side Arms	J	2	15mm Swan Neck Spacers
C	2	Clamp Plates	K	2	M12 x 110 Bolt (10.9) & Nyloc Nuts
D	2	Spacer Plates	L	8	M12 x 45 Bolts & Nyloc Nuts
F	1	ACS3 / 9203 Swan Neck	N	20	12 x 25 Flat Washers

Notes:-

1. This Towbar can also be installed on Ford Chassis Extensions mounted to the inside face of the chassis using the 145mm mounting points.
2. **Page 1** is for Auto-Trail Drop Down Floor models with **OEM** extensions. **Figures 1 & 2** Show the correct settings for mounting this Towbar.
3. **Page 2** is for Ford Based Internally Mounted Chassis Extensions with 145mm hole centres.

Autotrail Towbar Installation:-

1. Using **Figure 1** identify the correct position to mount the Towbar.
2. Using **Figure 2** loosely fix items **B** to the outside face of each chassis extension using items **L** with items **N** with items **C** on the inside of the chassis extensions.
3. Using items **L** with items **N** loosely fix item **A** to items **B** with items **D** in between as required.
4. Using items **K** with items **N** and items **J** fix item **F** and item **H** to item **A** to the position shown in **Figure 2**.
5. Fully tighten all fixings ensuring the Towbar is rigid, square, and secure.

Figure 1

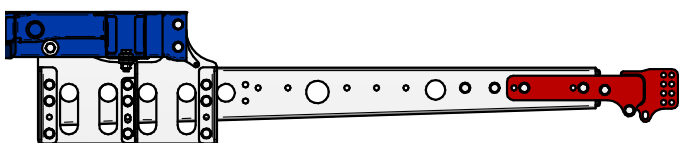

Figure 2

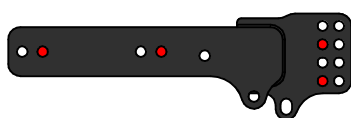
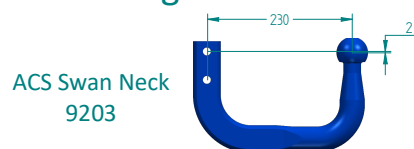
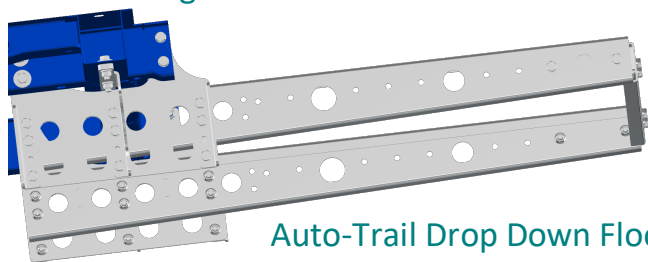

Figure 3



When Fitting To Models With OEM Chassis Extensions, Order TAUT9-CSK In Addition For Full Installation



Auto-Trail Drop Down Floor Models

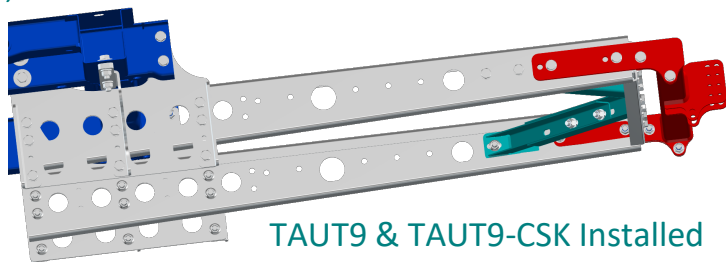

TAUT9 & TAUT9-CSK Installed

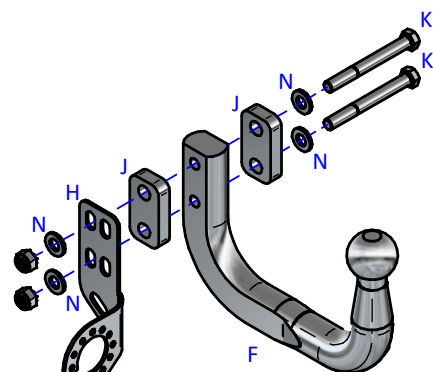
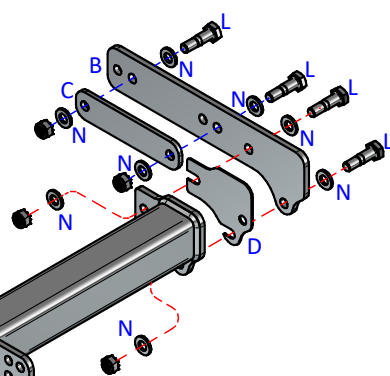
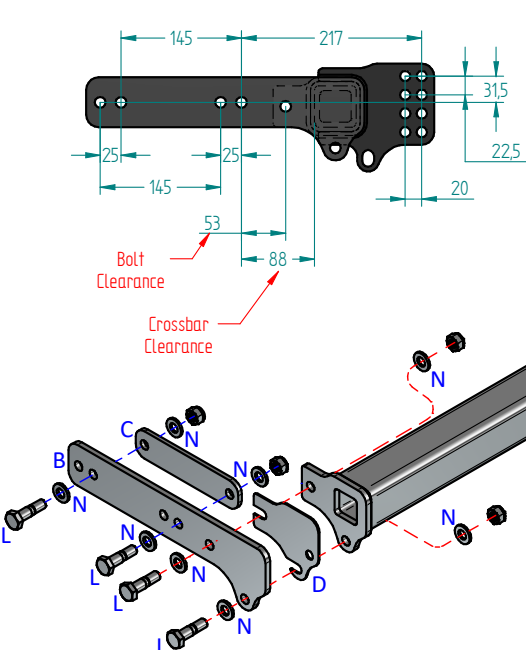

Notes:

1. For Torque settings see general notes overleaf.
2. Nose load limits and vehicle manufacturer's trailer / caravan weight limits must be observed.
3. We recommend the use of PRO-TOW Couplings with all our products.

Notes:-

1. This Page contains images and instructions only for mounting this Towbar to Ford Based Motorhomes with Chassis Extensions.
2. It is important that any Chassis Extensions fitted are check for suitability for towing and that there is a towing capacity before installation.
3. It is important that all dimensions are checked for suitability before purchase and fitment.
4. Some Chassis Extensions may require addition components before they become compatible with towing for example using **ATT-CHASS-CRS**.
5. **Figure 4** shows the chassis width and position the Towbar can be used with.

Towbar Installation:

1. Using **Figures 5, 6 & 7** identify the correct position to mount the Towbar.
2. Using **Figure 6** loosely fix items **B** to the outside face of each chassis extension using items **L** with items **N** with items **C** on the inside of the chassis extensions.
3. Using items **L** with items **N** loosely fix item **A** to items **B** with items **D** in between as required.
4. Using items **K** with items **N** and items **J** fix item **F** and item **H** to item **A** to the position best suited to the vehicle.
5. Fully tighten all fixings ensuring the Towbar is rigid, square, and secure.

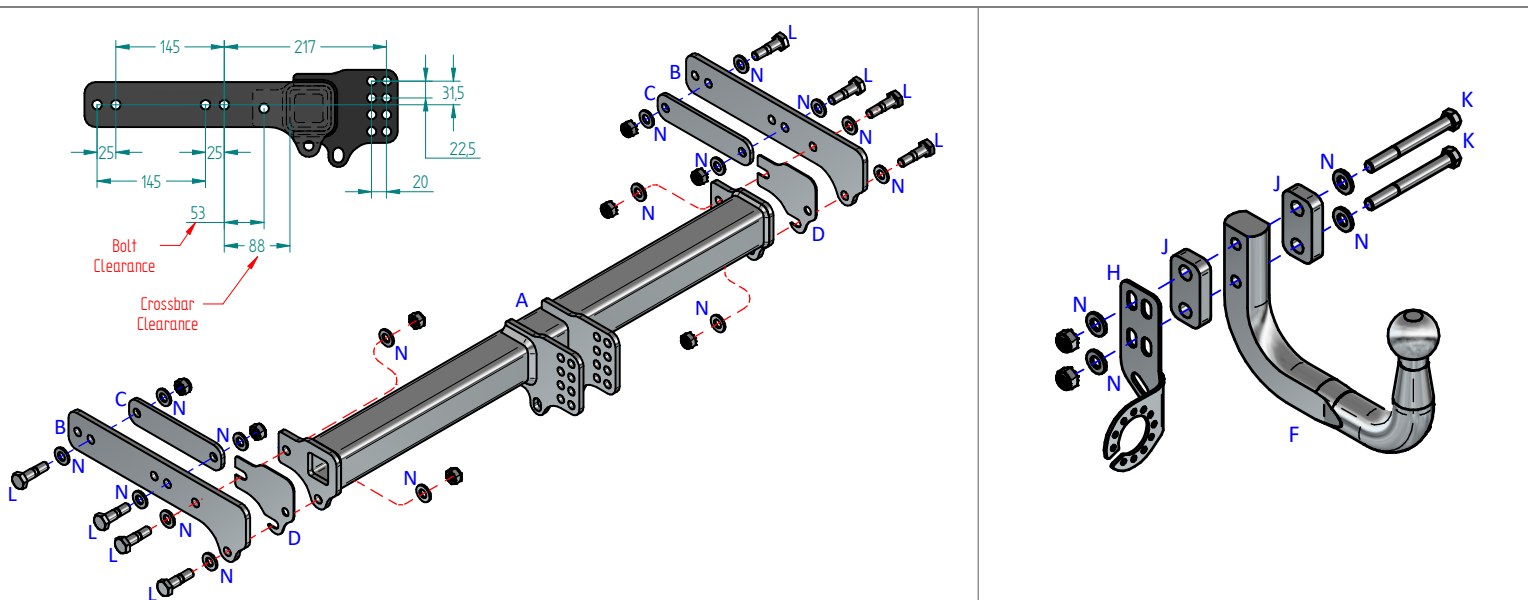
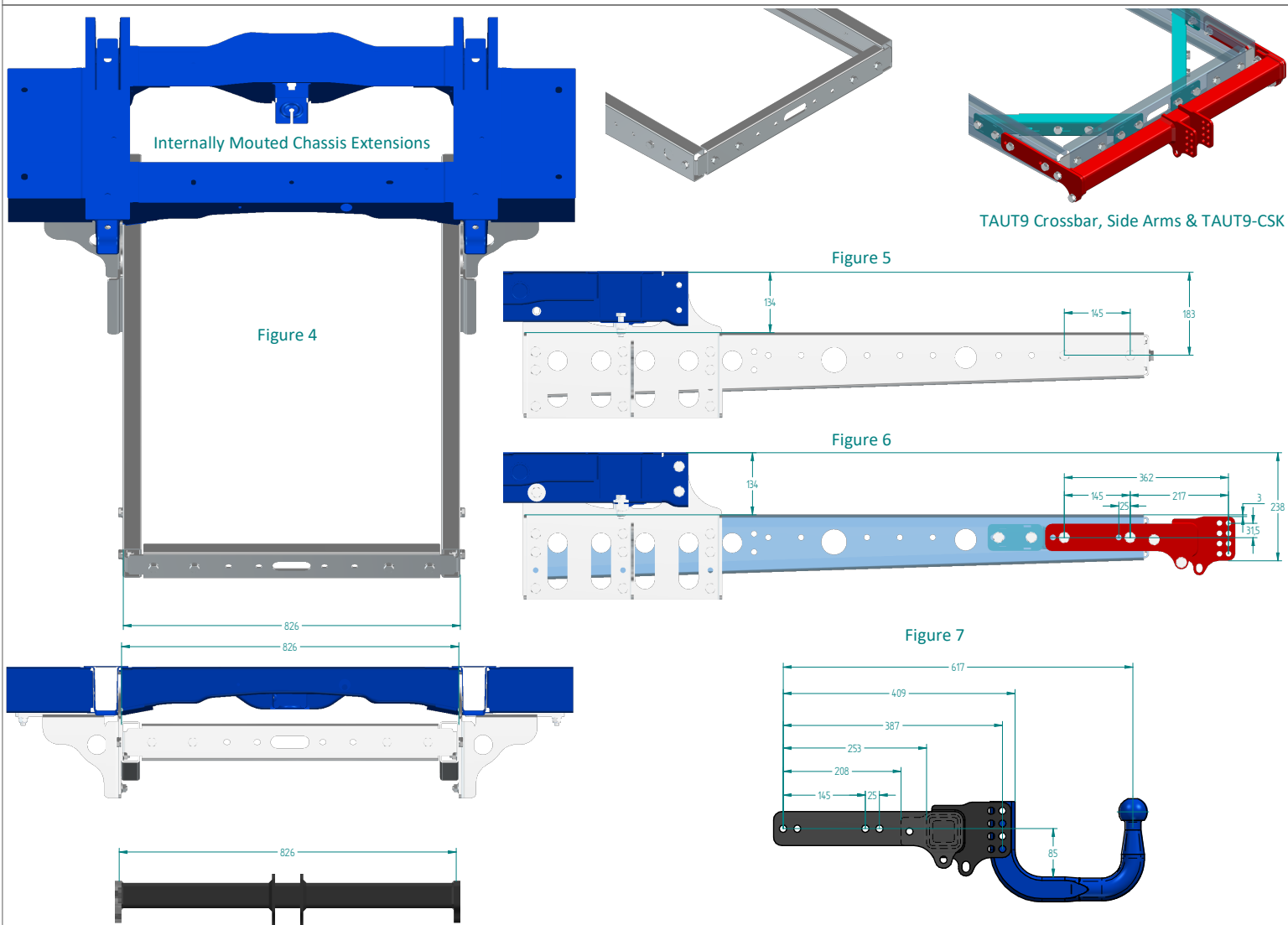

Notes:

1. For Torque settings see general notes overleaf.
2. Nose load limits and vehicle manufacturer's trailer / caravan weight limits must be observed.
3. We recommend the use of PRO-TOW Couplings with all our products