

## TREN20VK Renault Arkana (RJL) 2021>

Item	Qty	Description	Item	Qty	Description
A	1	TREN20 Crossbar	E	1	Flip Up Socket Plate (TTFP/LH)
B	2	Side Arms	F	2	M12 x 22 Bolts & S/P Washers
C	4	Chassis Spacers	G	2	M12 x 25 Bolts & S/P Washers
D	1	6#14 Detachable Neck	H	4	M12 x 45 Bolts & Nyloc Nuts
			J	4	M12 x 45 Bolts & S/P Washers
			K	12	12 x 25 Flat Washers
			L	4	12 x 30 Flat Washers

### Bumper Removal

1. Open the tailgate and remove the plastic bump stop and two fixings.
2. Remove the rear light clusters one fixing each side located internally and remove the two now revealed fixings from around the light cluster area from each side.
3. Remove the fixings along the bumpers lower edge including the ones for the wheel arch trim.
4. Remove the two fixings in the wheel arch on each side then unclip the trim from the bumper pulling away to gain access to the tip screw and remove.
5. Pull the bumper out sideways and rearwards and carefully separate any wiring looms to fully from the vehicle.
6. Cut the spare wheel well plastic cover in situ if present as shown in **Figure 1**.
7. Remove the impact beam, six fixings, (This is not reused with the Towbar assembly) then replace the fixings back into the rear panel.
8. Remove the tape covering the two mounting points in the chassis from each side.

### Towbar Installation

1. Loosely attach items **B** to the chassis using items **J** and items **L** with items **C**.
2. Loosely attach item **A** to items **B** using items **H** with items **K**.
3. Loosely attach item **D** and item **E** to item **A** using items **F** and items **G** with items **K**.
4. Fully tighten all the fixings ensuring the Towbar is rigid, square, and secure.
5. Cut the bumper using **Figure 2** as a guide then remount onto the vehicle.

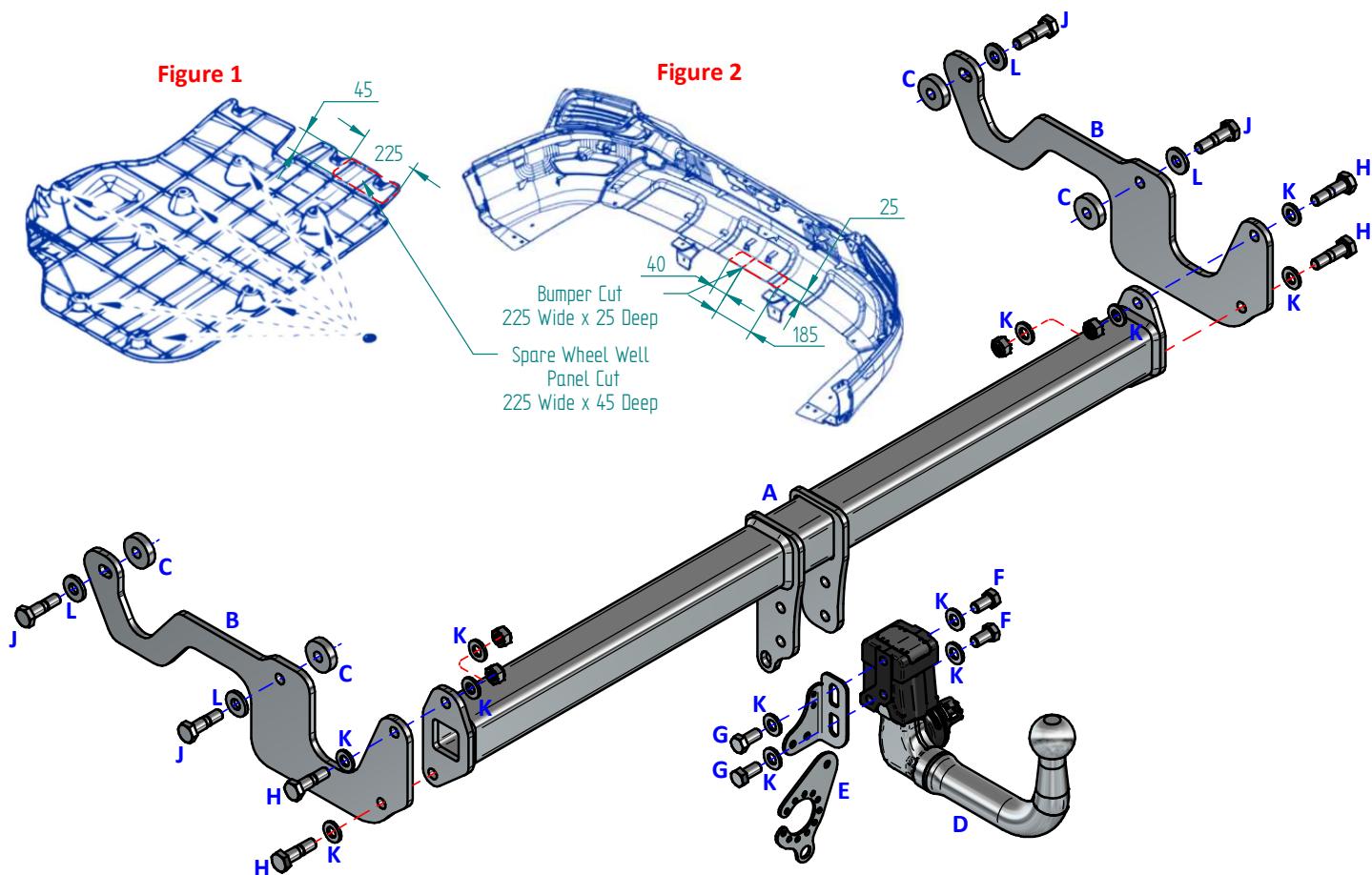

### Notes:

1. For Torque settings see general notes overleaf.
2. Nose load limits and vehicle manufacturer's trailer / caravan weight limits must be observed.
3. We recommend the use of PRO-TOW Couplings with all our products.