



# Tow-Trust Towbars

## TTRUPD03-IZ1 Fitting Instructions



### Isuzu NMR / NPR

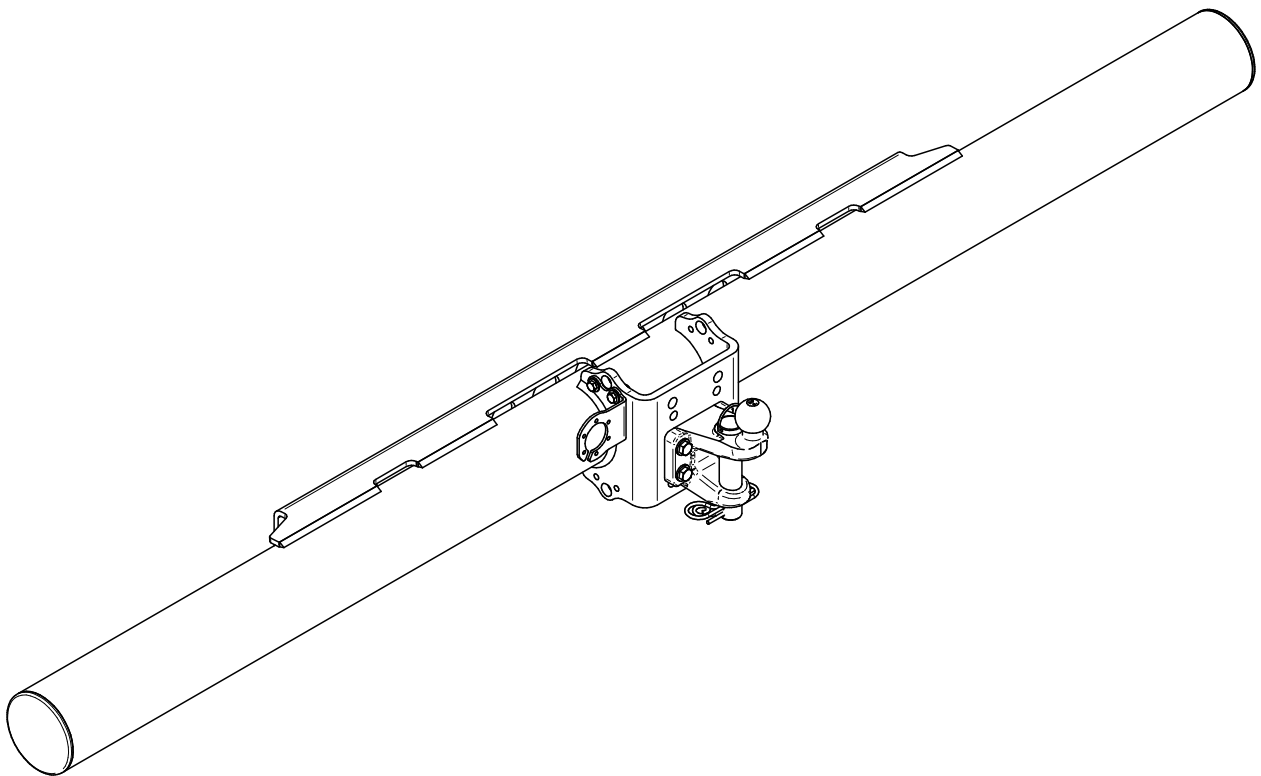

To Complete A Build.

Part No. TTRUPD03-TB-N2 (Beam)

Part No. TTRUPD03-IZ1 (Attachment Bracket Kit)

Part No. TTRUPD03-EXT (Optional, Rear Extension Plates)

Part No. AAHC/NATO (Optional Adjustable Height Coupling)



# Tow-Trust Towbars

## TTRUPD03-IZ1 Fitting Instructions

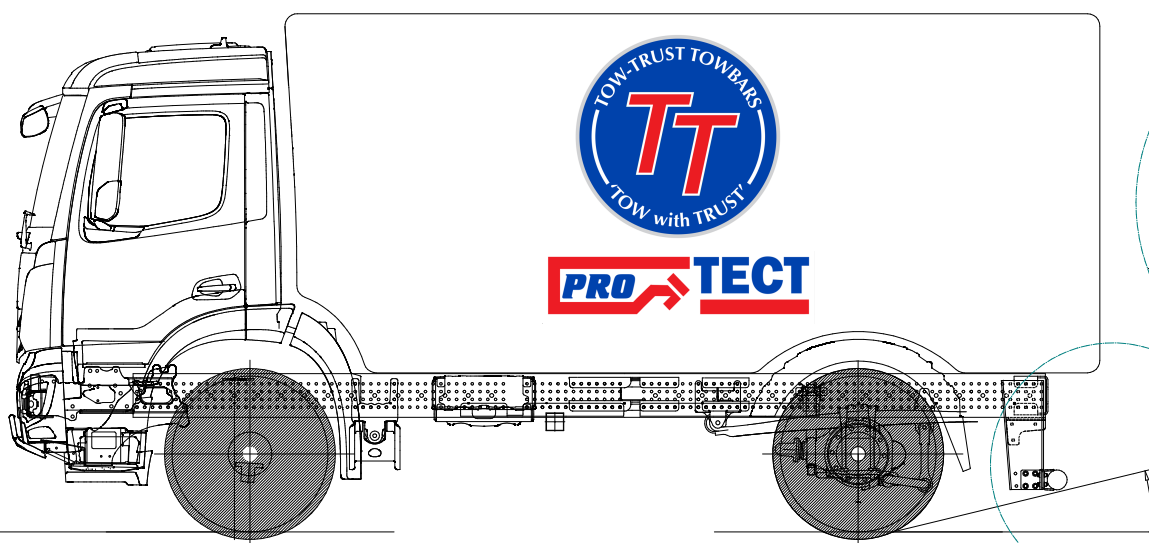

Vehicle Category Or Vehicle Type	Maximum Distance From Rear Of Vehicle	Ground Clearance Unladen Shall Not Exceed	Ground Clearance Unladen Shall Not Exceed (For Hydro-pneumatic, Hydraulic or Pneumatic suspension or a device for automatic self levelling according to load)	Ground Clearance Vehicles With A Departure Angle Of Up To 8 Degrees
N <sub>2</sub> 3.5T > 8T	408 mm	550 mm	N/A	N/A
N <sub>2</sub> 8T to 12T	408 mm	500 mm	450 mm	550 mm
N <sub>3</sub> 12T to 32T	408 mm	500 mm	450 mm	600 mm
Key To Diagrams	A	B	B	C

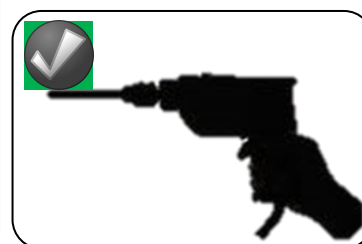
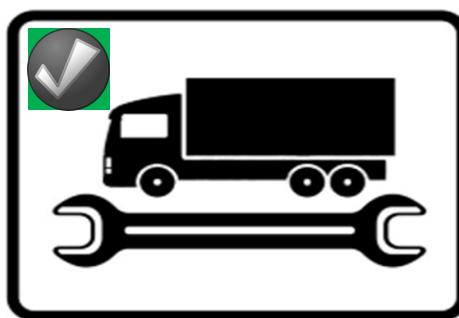
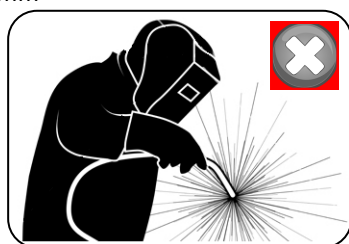
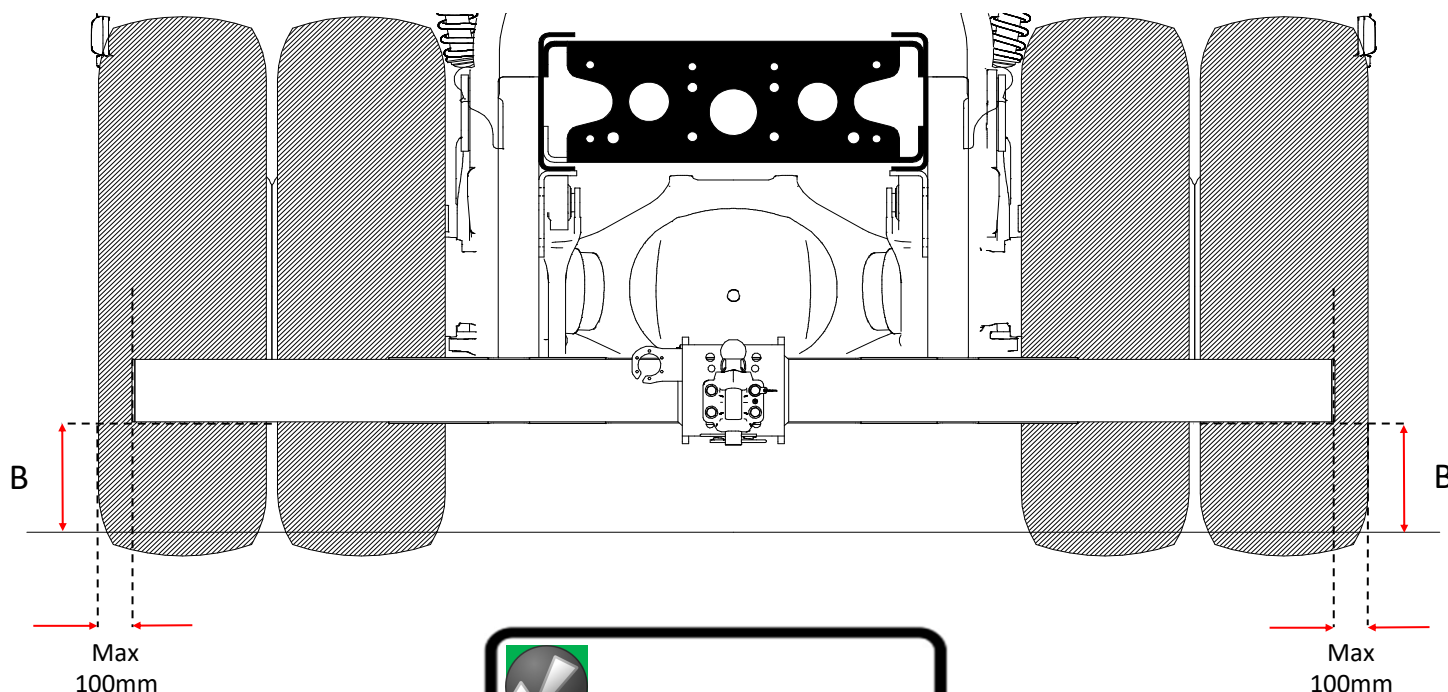



# Tow-Trust Towbars

## TTRUPD03-IZ1 Fitting Instructions



Items will be boxed as shown below.

Parts List: TTRUPD03-TB-N2 (Beam sold Separate)

1964mm

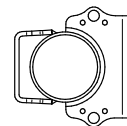
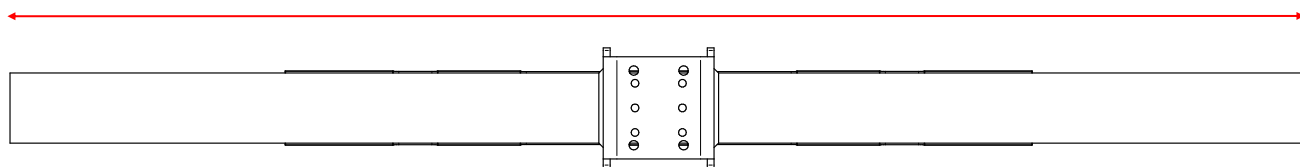

1 x TTRUPD03-TB-N2, 2 x 127 mm Plastic End Caps & 1 x TTRUPD03-7

Parts List: TTRUPD03-IZ1

TTRUPD03-1  
Handed

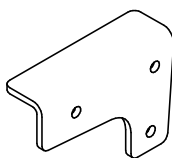

TTRUPD03-2

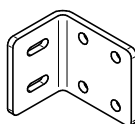

TTRUPD03-3



TTRUPD03  
Captive Nut  
Strap

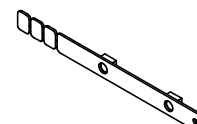

2 x TTRUPD03-1, 4 x TTRUPD03-2, 4 x TTRUPD03-3, 4 x TTRUPD03 Captive Nuts Straps

TTRUPD03-IZ1-1 ( Handed Side Arms)

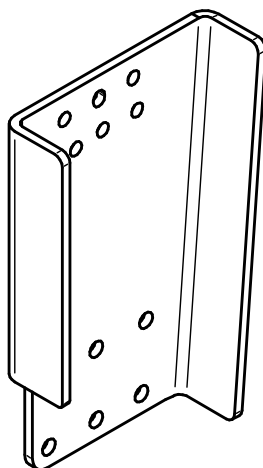
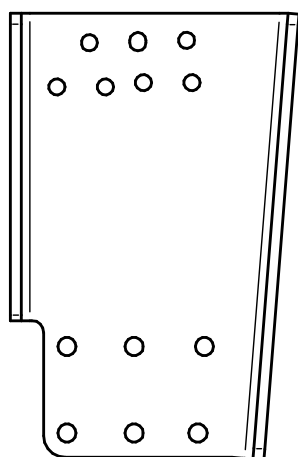

TTRUPD03-IZ1-2  
2 x Clamp Plates

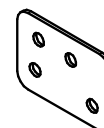
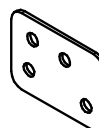

TTRUPD03-SP  
1 x Socket Plate

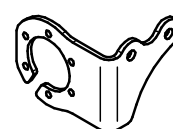

APBJ-4BS 1 x Ball Bracket

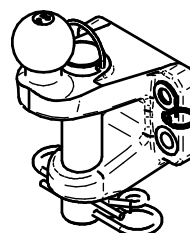

Optional Parts

AAHC/NATO

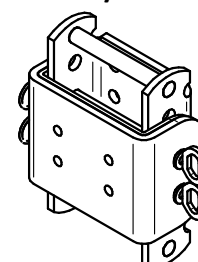

TTRUPD03-IZ1 Bolt Kit

- 14 x M16 x 50 mm (10.9) Flange Bolts & Flange Nuts.
- 16 x M14 x 50 mm (10.9) Flange Bolts & 8 x Flange Nuts.
- 4 x M12 x 55mm (10.9) Bolts & Nyloc Nuts.
- 2 x M8 x 30 mm Bolts & Nyloc Nuts.
- 3 x 12 x 25 Flat Washers.
- 4 x 8 x 20 Flat Washers.

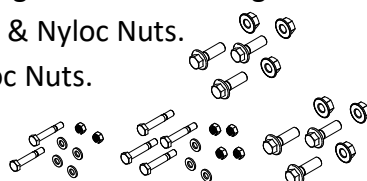

TTRUPD03-EXT

- 2 x TTRUPD03-EXT
- 8 x M16 x 50 mm (10.9) Flange Bolts & Flange Nuts

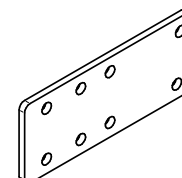
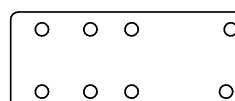



# Tow-Trust Towbars

## TTRUPD03-IZ1 Fitting Instructions



- 1. Loosely attach the side arm to the selected position using the M14 Bolts.**

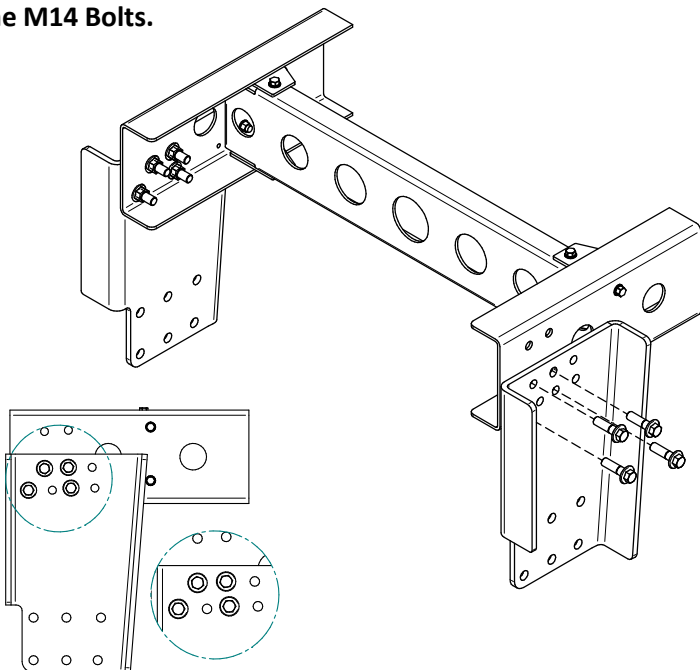

- 2. Mark off holes for TTRUPD03-1.  
Remove and open the holes out to 17mm.**

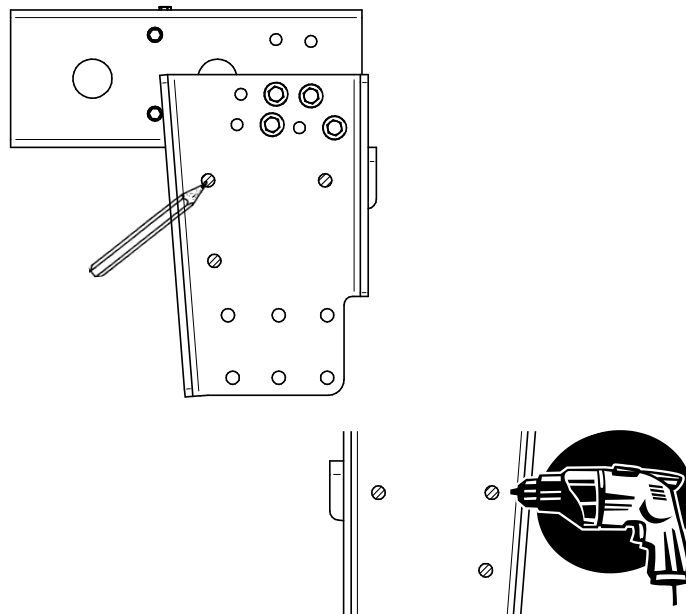

- 3. Remount the side arm to the chassis, ensuring the TTRUPD03-IZ1 CLAMP is fitted inside the chassis rail as shown below.**

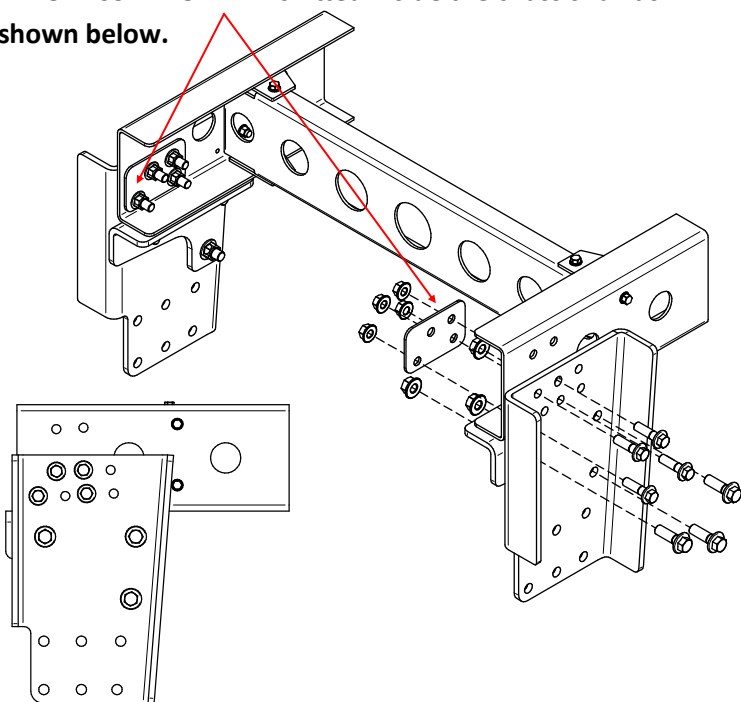

- 4. (Note skip this step if fitting TTRUPD03-EXT).  
Loosely bolt TTRUPD03-2 to the side arms using the M16 x 50 mm Bolts.**

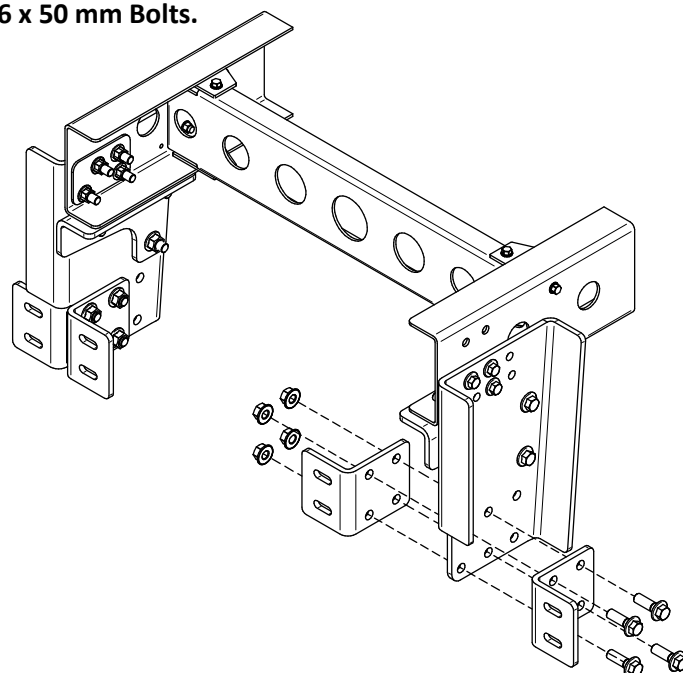

**Cut the crossbar to the required length with reference to the image on page 4.**

**As a guide 700mm wide NMR Chassis will need 70mm removed from each side.**

**Once the length is correct insert the plastic end caps.**

**This is applicable to TTRUPD03-NT and TTRUPD03-TB**





# Tow-Trust Towbars

## TTRUPD03-IZ1 Fitting Instructions



5. (Note skip this step if not fitting TTRUPD03-EXT).  
Loosely bolt TTRUPD03-EXT to the side arms using the kit supplied then fit TTRUPD03-2 to TTRUPD03-EXT as shown.

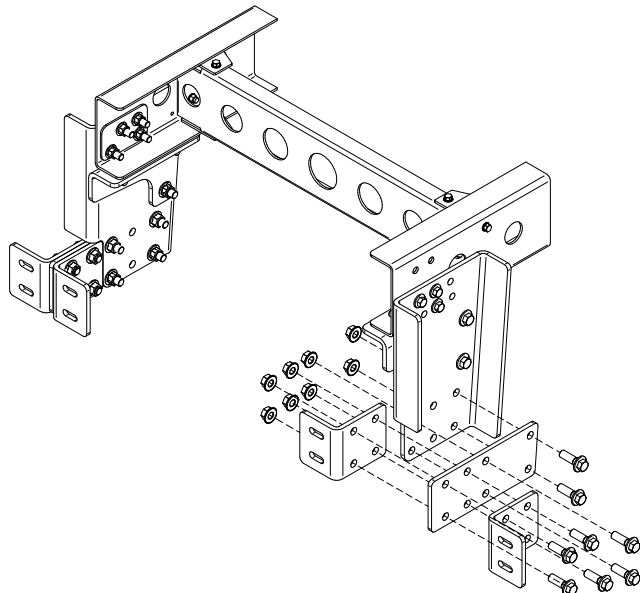

6. Loosely attach the crossbar keeping it central to the vehicle

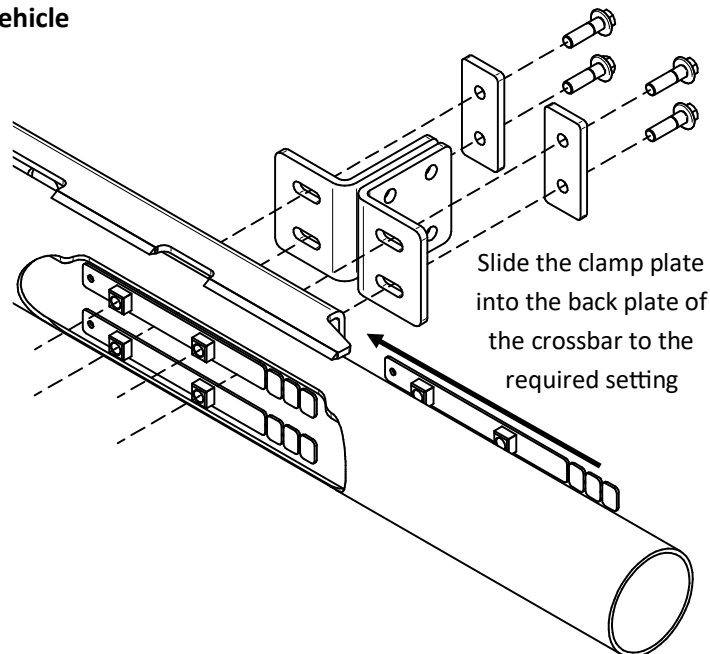

7. Fully tighten all fixings to the correct torque as shown below ensuring the complete assembly is rigid, square and secure.

M14 (10.9) 150 Nm

M16 (10.9) 252 Nm

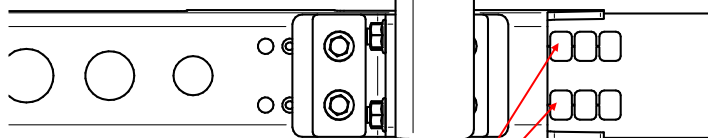

8. Once fully tightened break the protruding part of the clamp plate off by twisting it.

9. For TTRUPD03-TB-N2 Fix the supplied towball to the chosen setting with TTRUPD03-7 fitted behind flange plate.

M12 (10.9) 130 Nm

10. Fix TTRUPD03-SP using the kit supplied.

M8 (8.8) 25 Nm

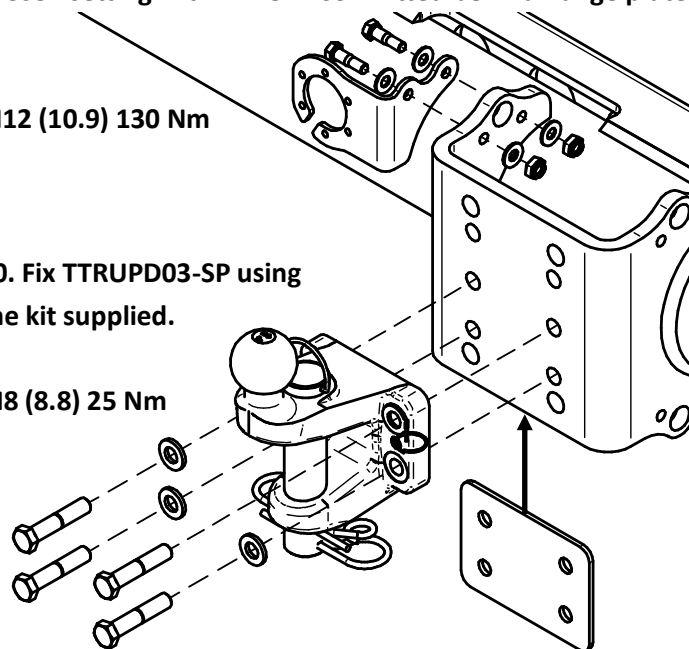

1500 Miles

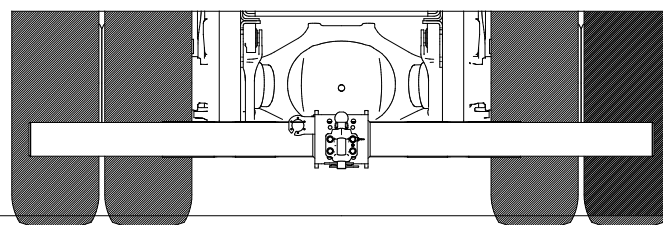
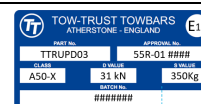
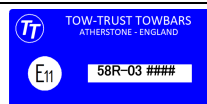
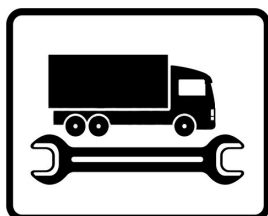



# Tow-Trust Towbars

## TTRUPD03-IZ1 Fitting Instructions



### Mounting Dimensions

#### TTRUPD03-IZ1

##### Forward Setting

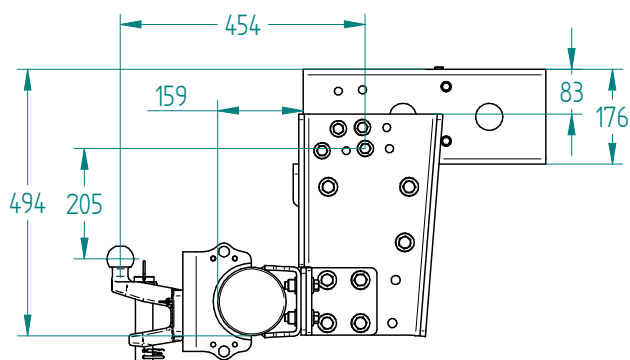

#### TTRUPD03-IZ1

##### TTRUPD03-EXT

##### Forward Setting

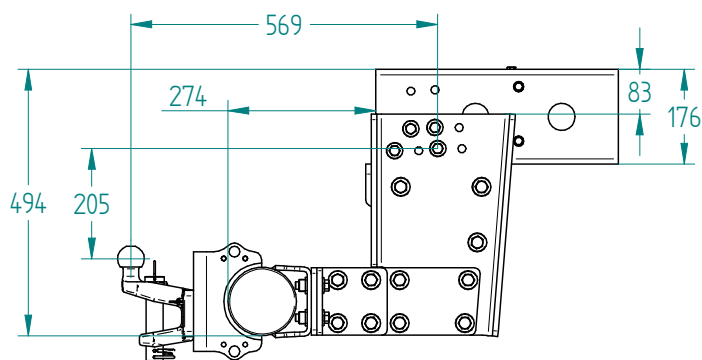

#### TTRUPD03-IZ1

##### Rear Setting

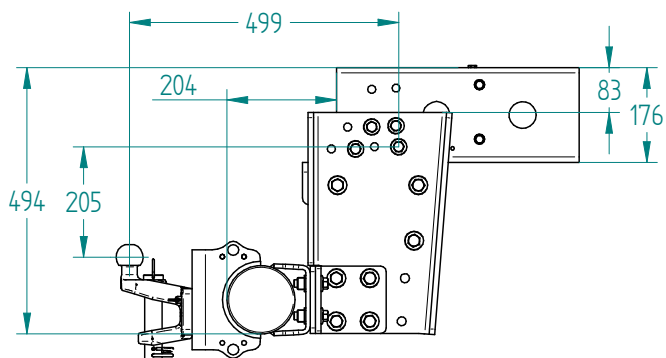

#### TTRUPD03-IZ1

##### TTRUPD03-EXT

##### Rear Setting

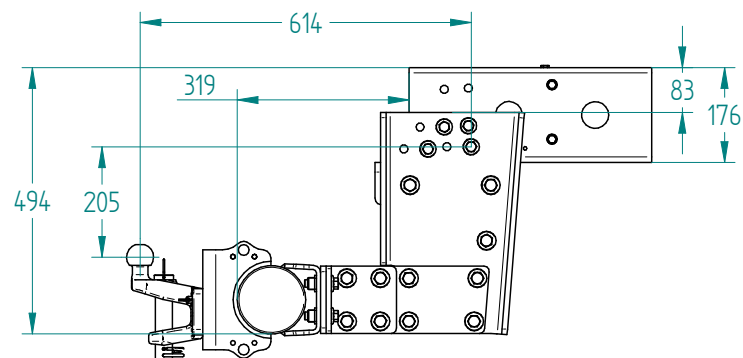

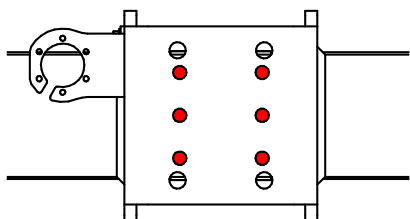

Only use the highlighted mounting points for attachment of the towball

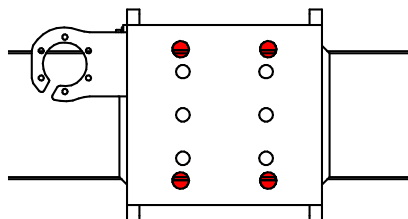

The remaining mounting points are only for use in conjunction with AAHC/NATO.

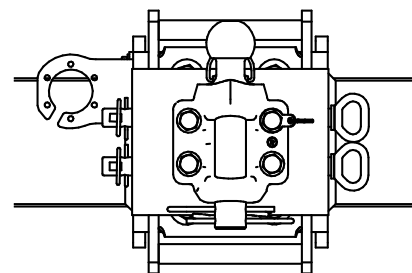

AAHC/NATO optional.  
It is only included for illustration purposes.

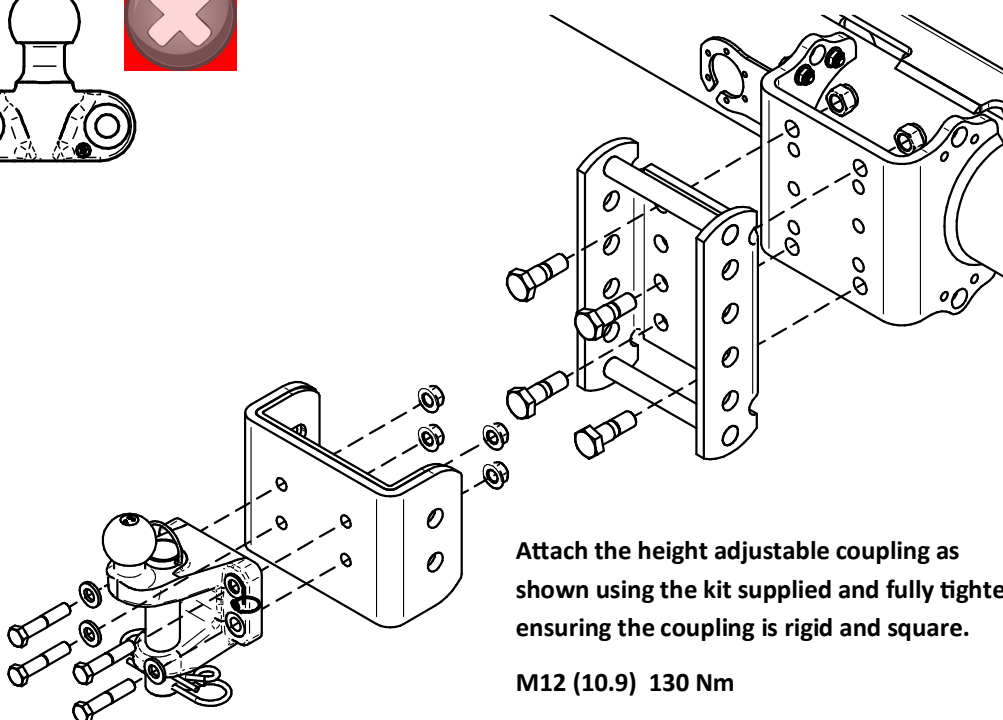
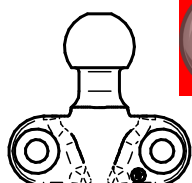
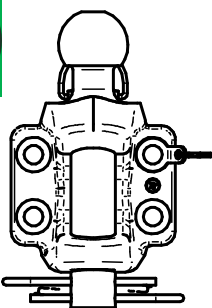

Attach the height adjustable coupling as shown using the kit supplied and fully tighten ensuring the coupling is rigid and square.

M12 (10.9) 130 Nm

M16 (10.9) 252 Nm

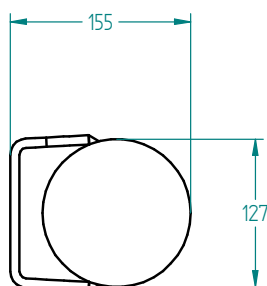

TTRUPD03-NT

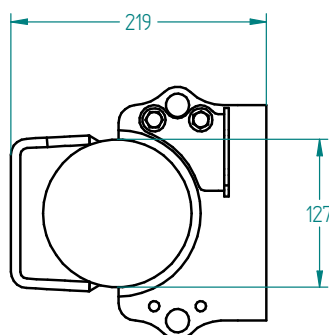

TTRUPD03-TB

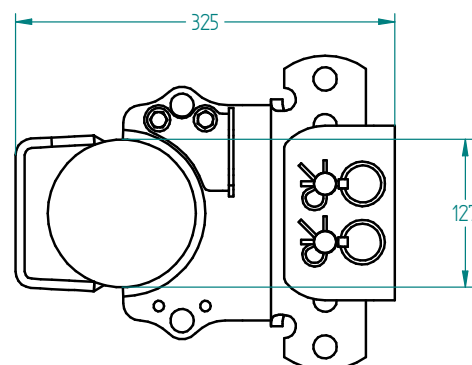

TTRUPD03-TB & AAHC/NATO



# Tow-Trust Towbars

## TTRUPD03-IZ1 Fitting Instructions

