



Tow-Trust Towbars

TTRUPD03 Fitting Instructions



TTRUPD03-NT

REG 58.03

NON TOWING BEAM

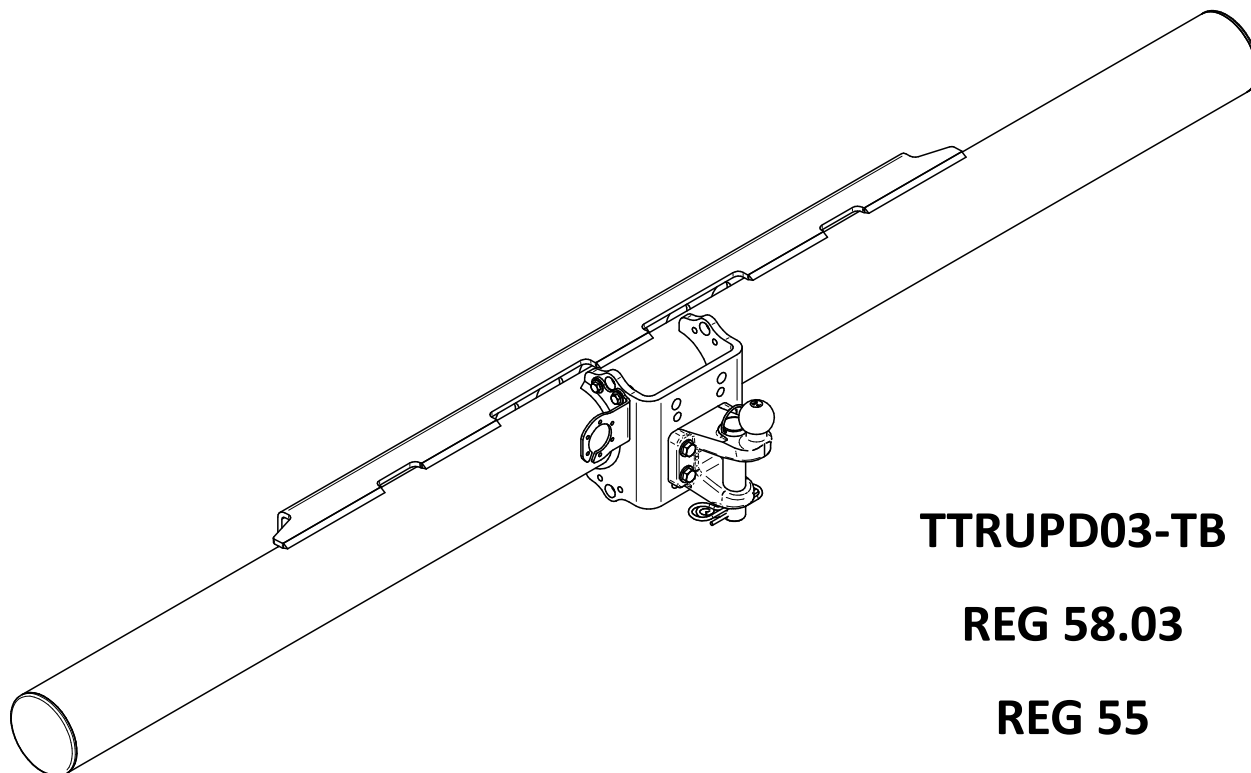
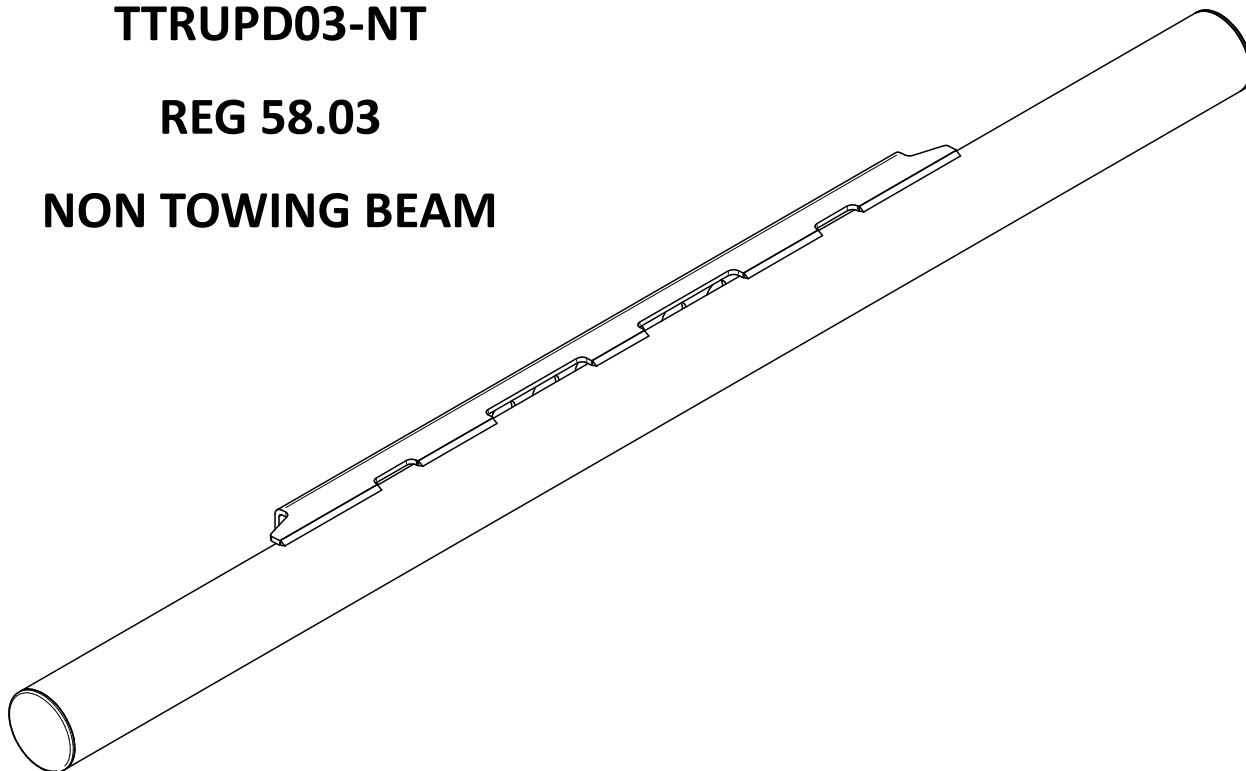

TTRUPD03-TB

REG 58.03

REG 55

TOWING BEAM

Can Be Fitted To Any Vehicle From 3500 Kg To 32000 Kg GVW



Tow-Trust Towbars

TTRUPD03 Fitting Instructions

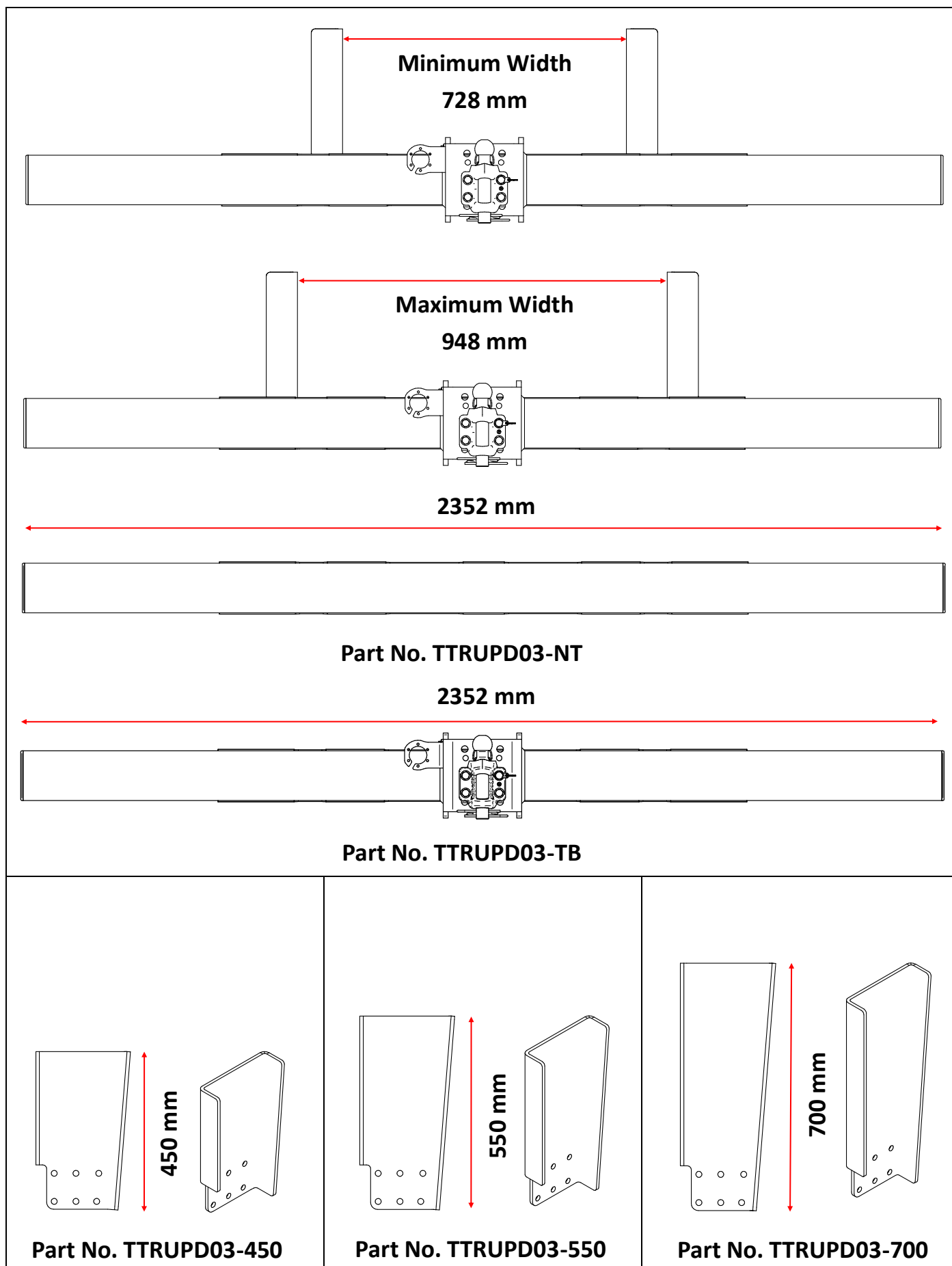



Tow-Trust Towbars

TTRUPD03 Fitting Instructions



Please Use As A Reference To Establish All The Parts Required Before Ordering The Product!

TTRUPD03-NT



TTRUPD03-TB

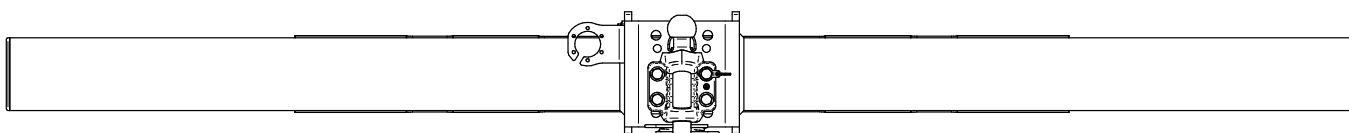

Minimum Part Requirements For Towing & Non Towing

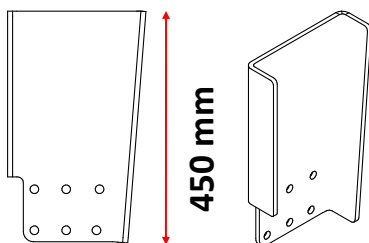

Part No. TTRUPD03-450

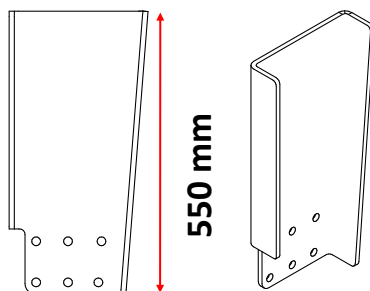

Part No. TTRUPD03-550

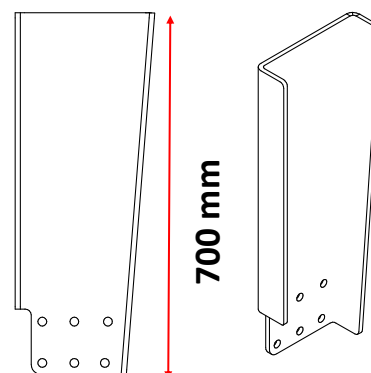

Part No. TTRUPD03-700

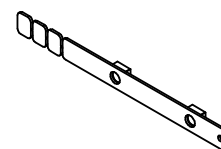
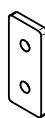
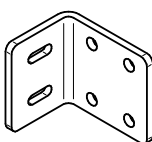
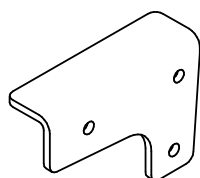

TTRUPD03-BKT All Versions Require These Parts Which Come With Required Fixing Kits

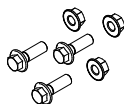

TTRUPD03-M14
Depending On Chassis

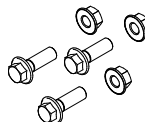

TTRUPD03-M16
Depending On Chassis

Bolt Kit Part Numbers Below:-

TTRUPD03-M14-10
TTRUPD03-M14-24
TTRUPD03-M14-30
TTRUPD03-M16-14
TTRUPD03-M16-18
TTRUPD03-M16-24

Optional Additional Requirements All Come With Fixing Kits excluding APBJ-4BS

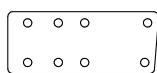

TTRUPD03-EXT

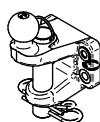

APBJ-4BS



APBJ-M12
For use With
APBJ-4BS

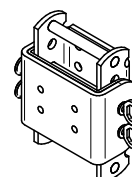

AAHC/NATO



TTRUPD03-SP



Tow-Trust Towbars

TTRUPD03 Fitting Instructions



Note:- All versions shown below will require additional bolt kits for the chassis.

TTRUPD03-NT TTRUPD03-BKT TTRUPD03-450	TTRUPD03-NT TTRUPD03-BKT TTRUPD03-450 TTRUPD03-EXT	TTRUPD03-TB TTRUPD03-BKT TTRUPD-450 APBJ-4BS APBJ-M12	TTRUPD03-TB TTRUPD03-BKT TTRUPD03-450 TTRUPD-EXT APBJ-4BS APBJ-M12
TTRUPD03-NT TTRUPD03-BKT TTRUPD03-550 TTRUPD03-BKT	TTRUPD03-NT TTRUPD-BKT TTRUPD03-550 TTRUPD03-EXT	TTRUPD03-TB TTRUPD03-BKT TTRUPD-550 APBJ-4BS APBJ-M12	TTRUPD03-TB TTRUPD03-BKT TTRUPD03-550 TTRUPD-EXT APBJ-4BS APBJ-M12
TTRUPD03-NT TTRUPD03-BKT TTRUPD03-700	TTRUPD03-NT TTRUPD03-BKT TTRUPD03-700 TTRUPD03-EXT	TTRUPD03-TB TTRUPD03-BKT TTRUPD-700 APBJ-4BS APBJ-M12	TTRUPD03-TB TTRUPD03-BKT TTRUPD03-700 TTRUPD-EXT APBJ-4BS APBJ-M12

Minimum Hole Patterns To Be Drilled As Required

Hole Patterns Must Always Be Drilled With A Minimum Of 25mm Of Material Above Measured From The Hole Centre.

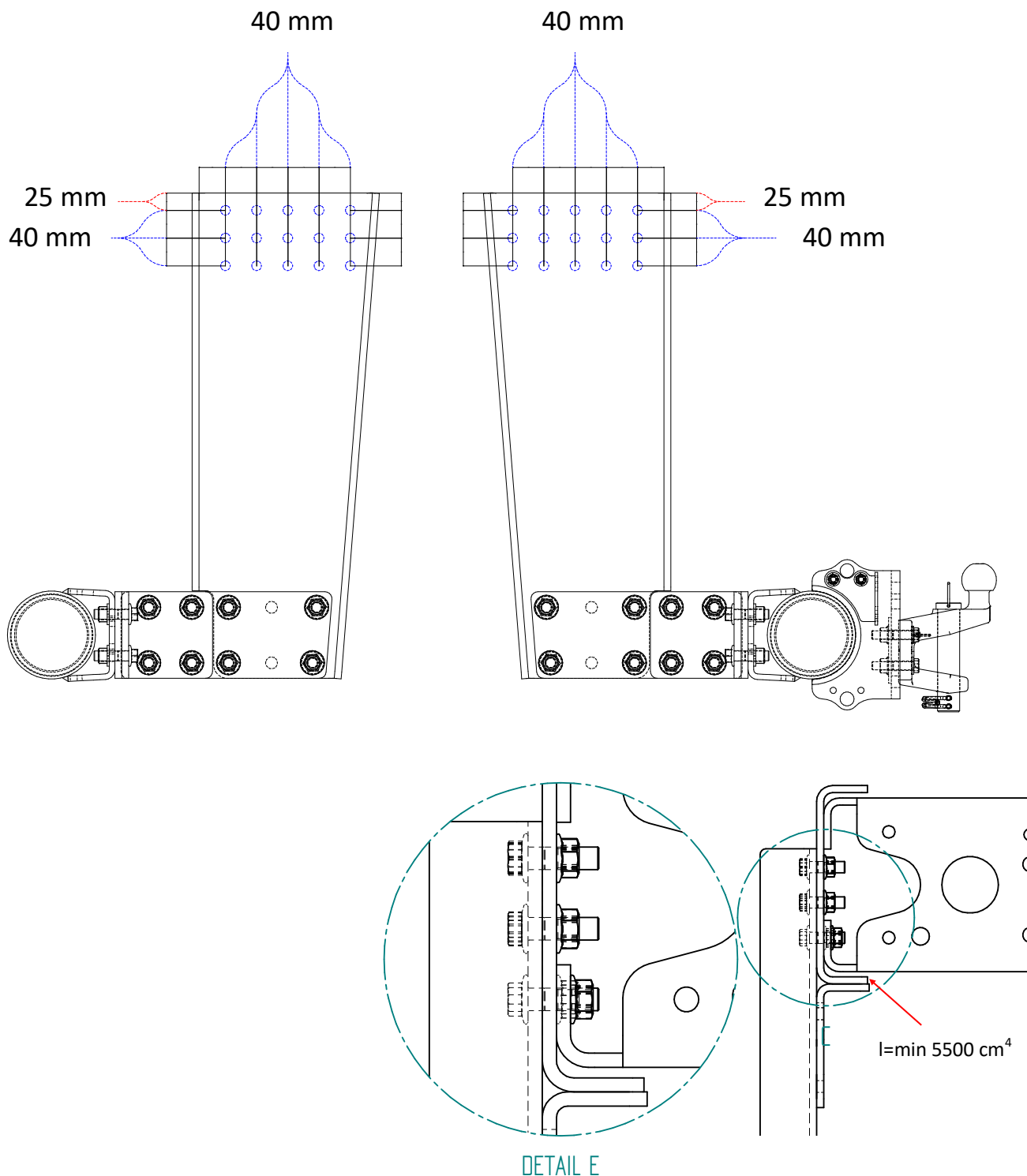



Tow-Trust Towbars

TTRUPD03 Fitting Instructions



Minimum Hole Patterns To Be Drilled As Required

It is advised that the RUPD is fitted with reference to the appropriate body builders guide

Note: The minimum number of fixings stated is per pair of attachment brackets.

We would always advice to use as many fixings as possible.

The images shown are to be used purely as a guide.

N ₃ & N ₂ 8000 Kg To 32000 Kg Minimum Configurations Shown Below			N ₂ Less Than 8000 kg Minimum Configurations Shown Below
TTRUPD03-700 30 x M14	TTRUPD03-550 24 x M14	TTRUPD03-450 18 x M14	N ₂ >8000 kg Only TTRUPD03-550 10 x M14
TTRUPD03-700 24 x M16	TTRUPD03-550 18 x M16	TTRUPD03-450 14 x M16	N ₂ >8000 kg Only TTRUPD03-450 8 x M14



Tow-Trust Towbars

TTRUPD03 Fitting Instructions

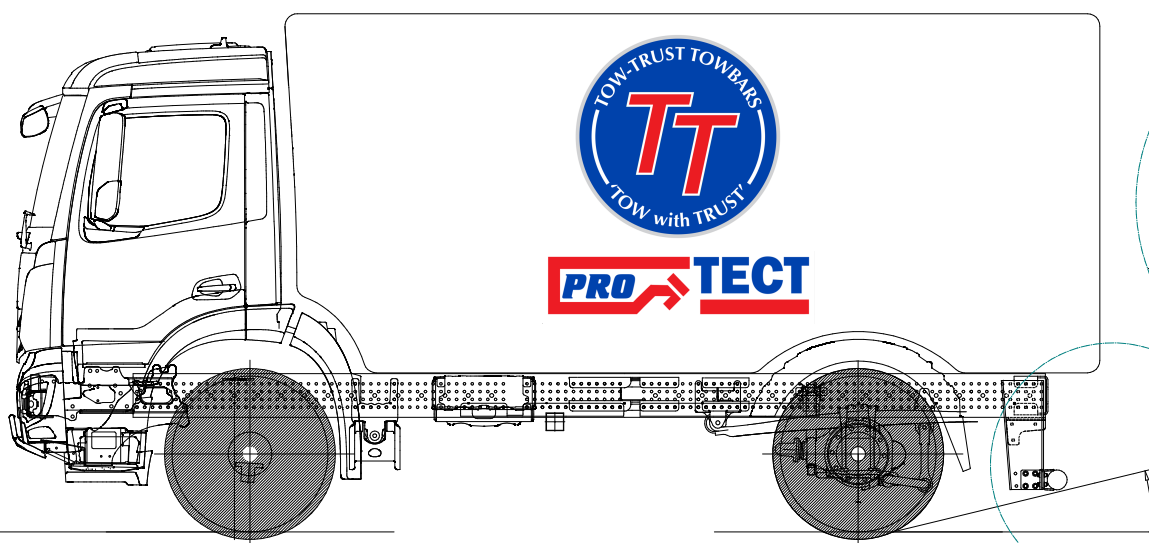

Vehicle Category Or Vehicle Type	Maximum Distance From Rear Of Vehicle	Ground Clearance Unladen Shall Not Exceed	Ground Clearance Unladen Shall Not Exceed (For Hydro-pneumatic, Hydraulic or Pneumatic suspension or a device for automatic self levelling according to load)	Ground Clearance Vehicles With A Departure Angle Of Up To 8 Degrees
N ₂ 3.5T > 8T	408 mm	550 mm	N/A	N/A
N ₂ 8T to 12T	408 mm	500 mm	450 mm	550 mm
N ₃ 12T to 32T	408 mm	500 mm	450 mm	600 mm
Key To Diagrams	A	B	B	C

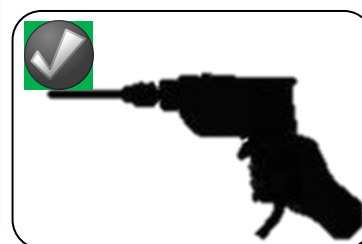
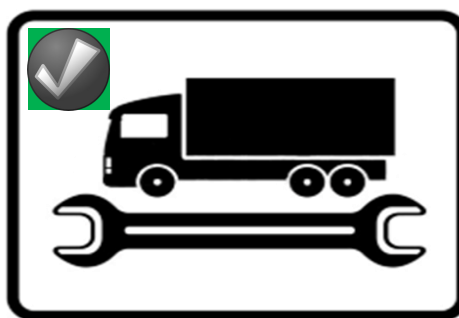
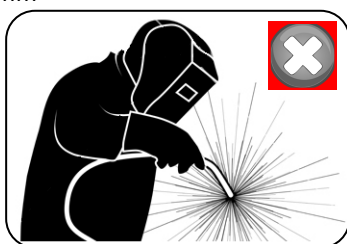
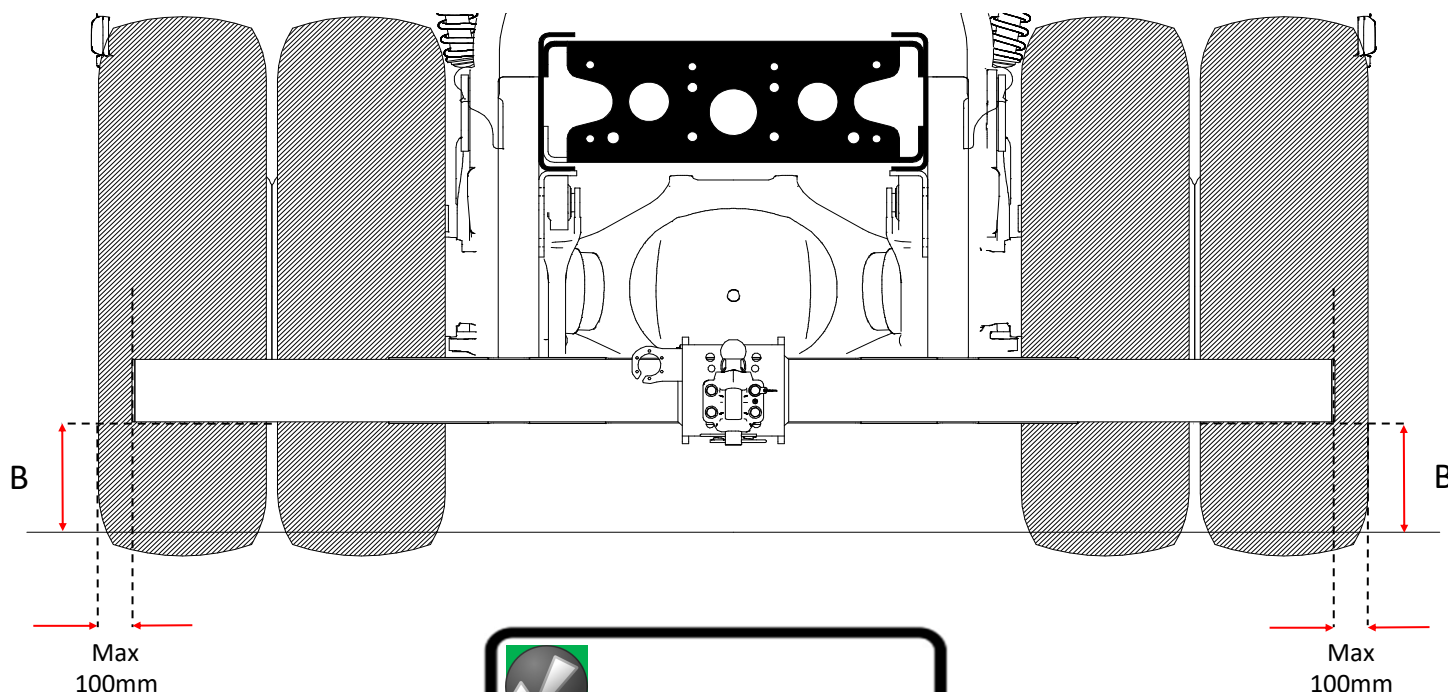



Tow-Trust Towbars

TTRUPD03 Fitting Instructions



Items will be boxed as below with individual fitting kits please check before fitting.

Parts List: TTRUPD03-NT

2340 mm

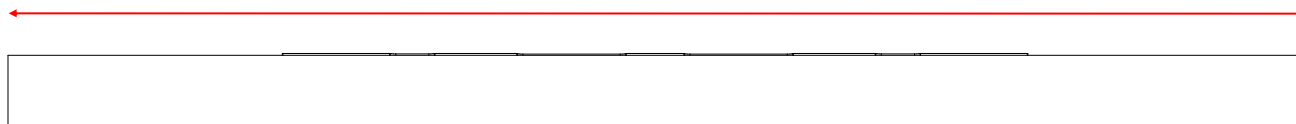

1 x TTRUPD03-NT, 2 x 127 mm Plastic end caps.

Parts List: TTRUPD03-TB

2340 mm

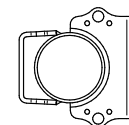
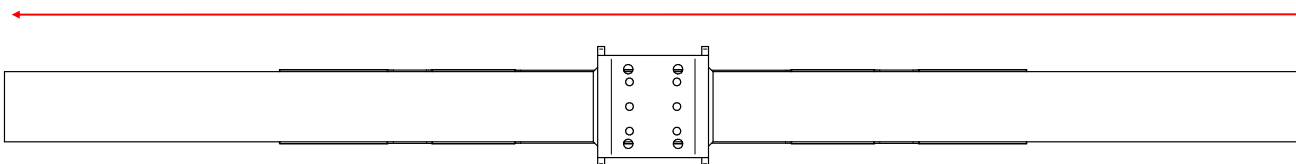

1 x TTRUPD03-TB, 2 x 127 mm Plastic End Caps & 1 x TTRUPD03-7.



Parts List: TTRUPD03-BKT

TTRUPD03-1
Handed

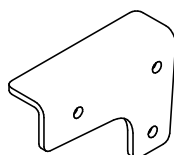

TTRUPD03-2

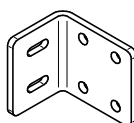

TTRUPD03-3

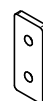

TTRUPD03
Captive Nut
Strap

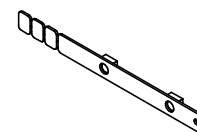

2 x TTRUPD03-1, 4 x TTRUPD03-2, 4 x TTRUPD03-3, 4 x TTRUPD03 Captive Nuts Straps
14 x M16 x 50 mm (10.9) Flange Bolts & Flange Nuts, 8 x M14 x 50 mm (10.9) Flange Bolts.

TTRUPD03-450 (2 Handed Parts)

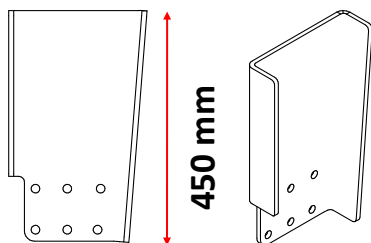

450 mm

TTRUPD03-550 (2 Handed Parts)

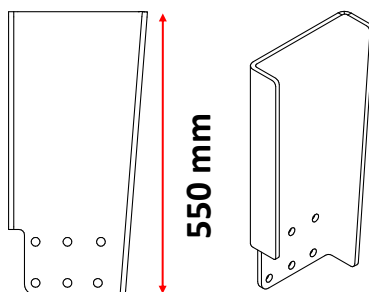

550 mm

TTRUPD03-700 (2 Handed Parts)

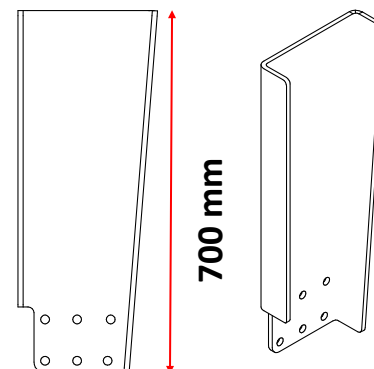

700 mm

Optional Parts

2 x TTRUPD03-EXT

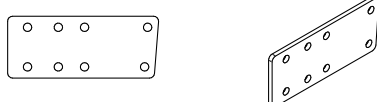

8 x M16 x 50 mm (10.9) Flange Bolts & Flange Nuts

TTRUPD03-M14 or M16

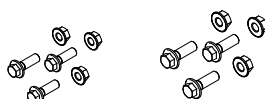

APBJ-M12

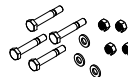

APBJ-4BS

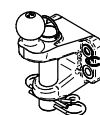

AAHC/NATO

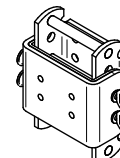

TTRUPD03-SP



2 x M8 x 30 Bolts & Nyloc Nuts.
4 x 8 x 20 Flat Washers



Tow-Trust Towbars

TTRUPD03 Fitting Instructions



1. Mark off holes in attachment brackets at required height.

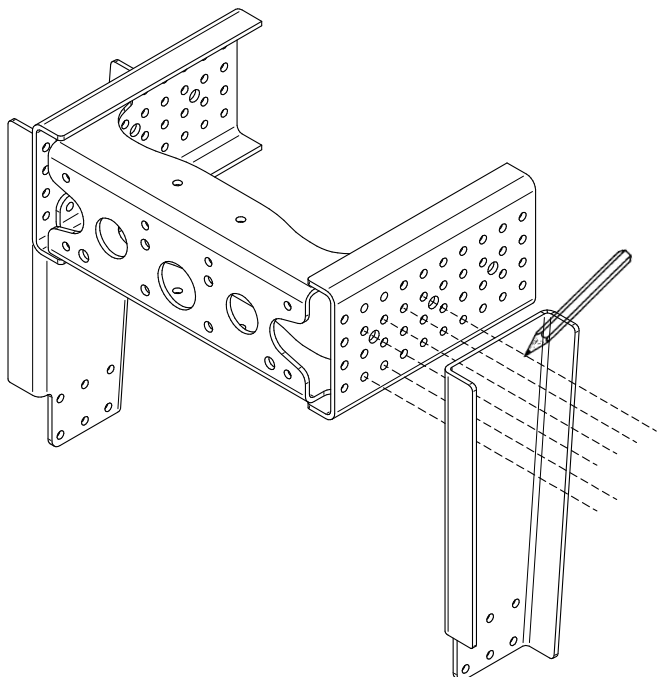

2. Drill holes in attachment brackets at required height and cut off unnecessary material if required.

Ensure that the attachment brackets are drilled to the size that matches the Chassis

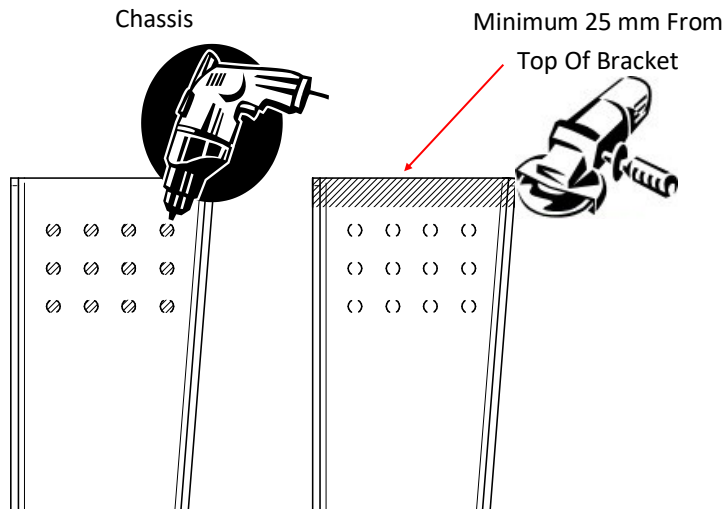

3. Loosely bolt attachment brackets to the vehicle chassis.

Mark off holes for TTRUPD03-1.

Remove and open the holes out to 17mm ,then remount the attachment brackets and TTRUPD03-1

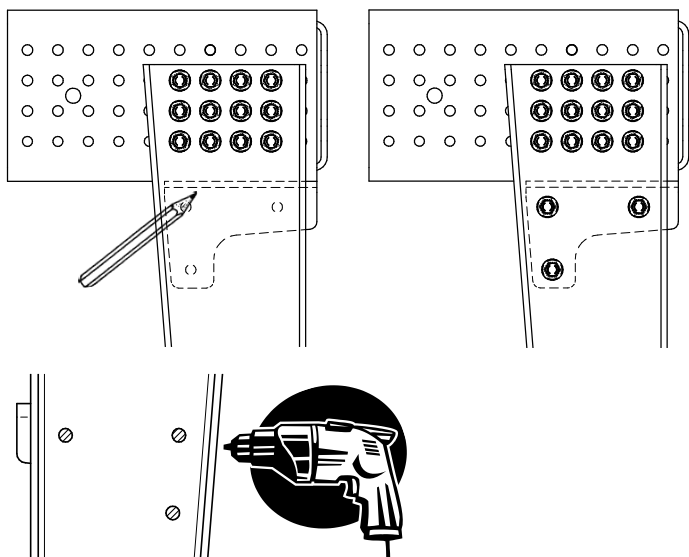

4. (Note skip this step if fitting TTRUPD03-EXT).

Loosely bolt TTRUPD03-2 to the attachment brackets using the kit supplied.

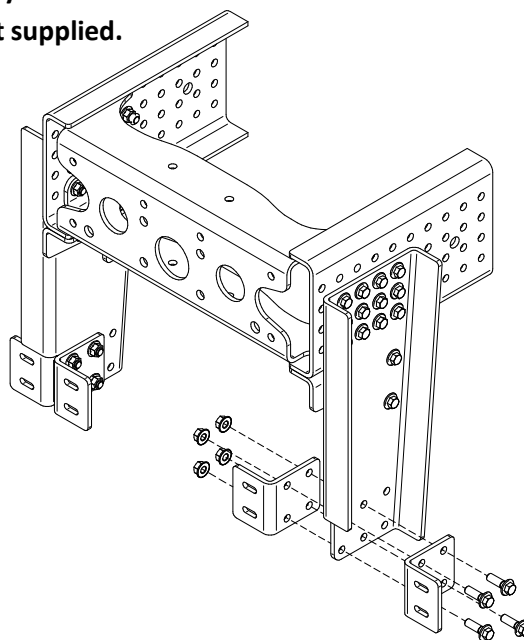

Cut the crossbar to the required length with reference to the image on page 7.

(N₂ Vehicles will generally need 174mm removing from each side).

Once the length is correct insert the plastic end caps.

This is applicable to TTRUPD03-NT and TTRUPD03-TB





Tow-Trust Towbars

TTRUPD03 Fitting Instructions



5. (Note skip this step if not fitting TTRUPD03-EXT).

Loosely bolt TTRUPD03-EXT to the attachment brackets using the kit supplied then fit TTRUPD03-2 to TTRUPD03-EXT as shown.

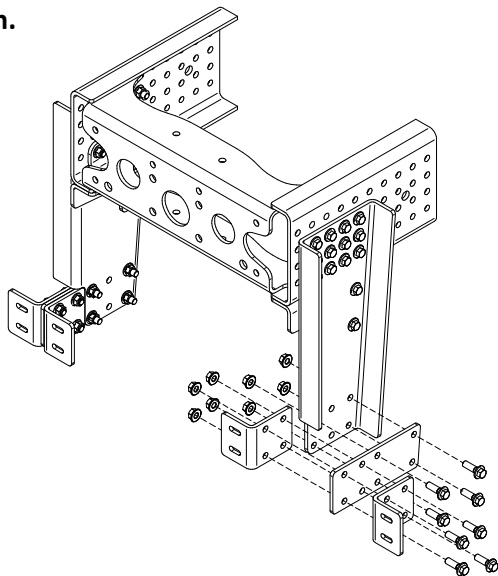

6. Loosely attach the crossbar keeping it central to the vehicle

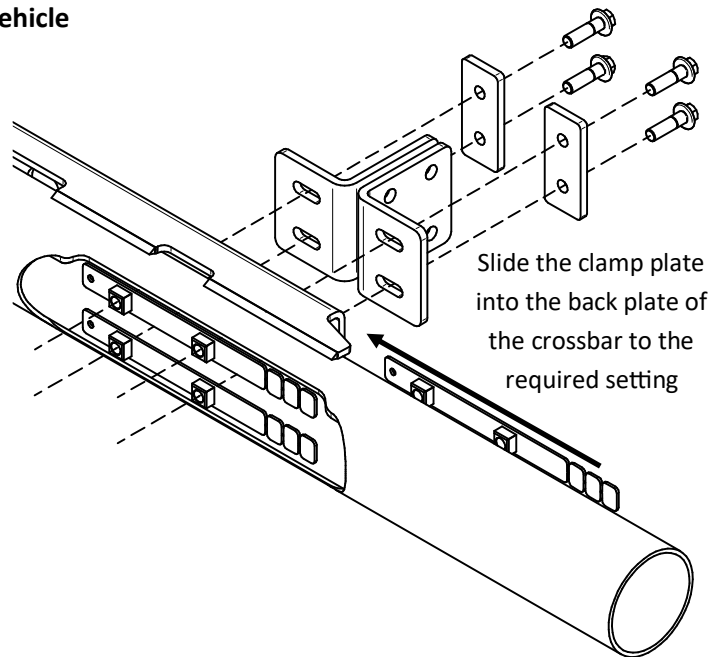

Slide the clamp plate into the back plate of the crossbar to the required setting

7. Fully tighten all fixings to the correct torque as shown below ensuring the complete assembly is rigid, square and secure.

M14 (10.9) 150 Nm

M16 (10.9) 252 Nm

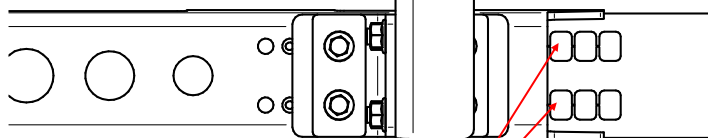

8. Once fully tightened break the protruding part of the clamp plate off by twisting it.

9. For TTRUPD03-TB Fix the towball to the chosen setting with TTRUPD03-7 fitted behind flange plate.

M12 (10.9) 130 Nm

10. Fix TTRUPD03-SP using the kit supplied.

M8 (8.8) 25 Nm

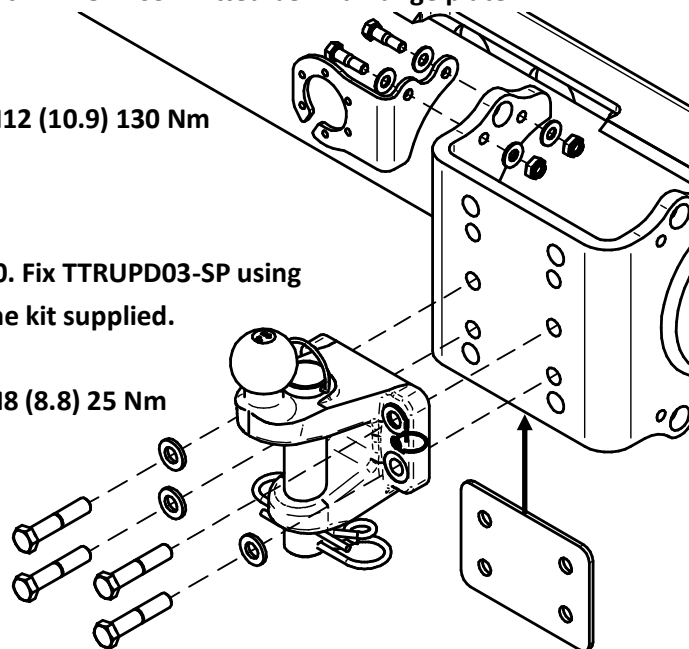

1500 Miles

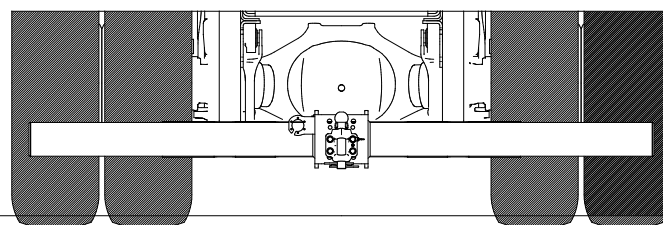
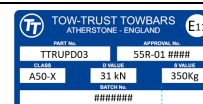
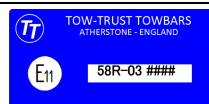

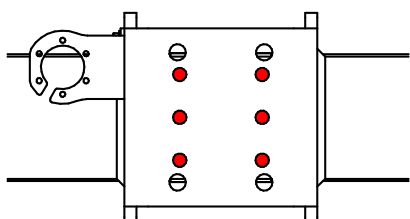

Only use the highlighted mounting points for attachment of the towball

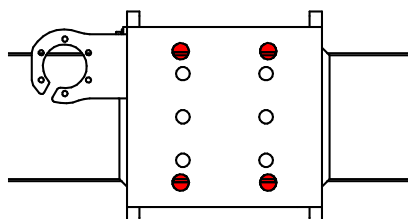

The remaining mounting points are only for use in conjunction with AAHC/NATO.

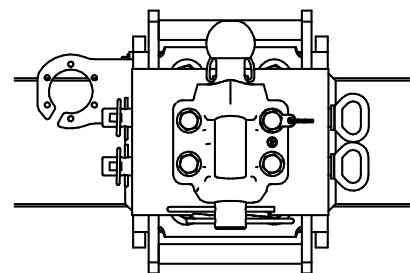

The Socket Plate is optional. It is only included for illustration purposes.

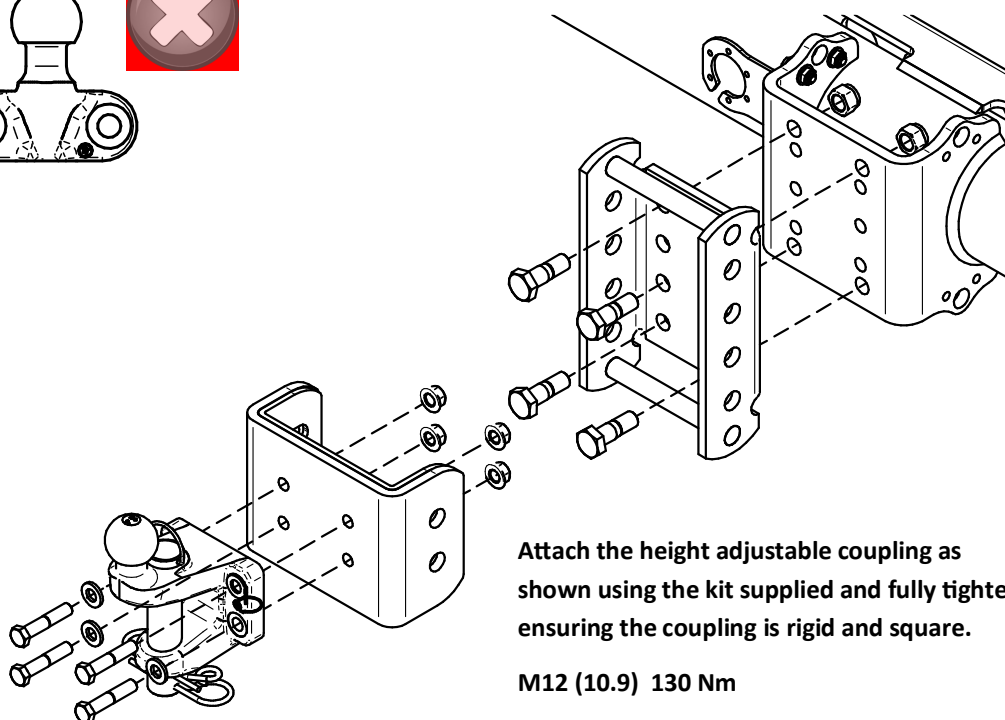
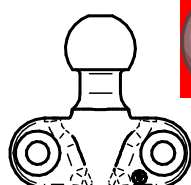
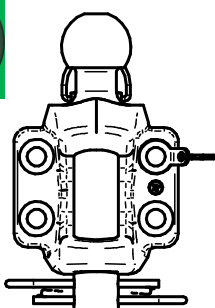

Attach the height adjustable coupling as shown using the kit supplied and fully tighten ensuring the coupling is rigid and square.

M12 (10.9) 130 Nm

M16 (10.9) 252 Nm

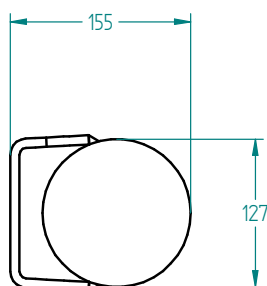

TTRUPD03-NT

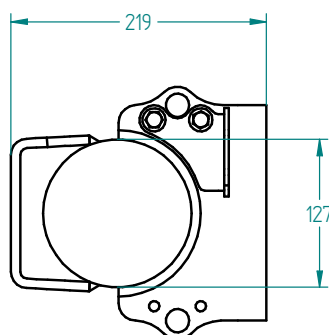

TTRUPD03-TB

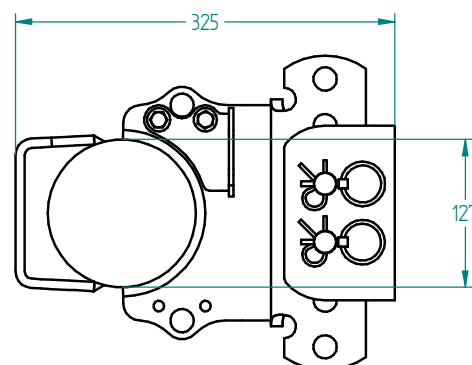

TTRUPD03-TB & AAHC/NATO



Tow-Trust Towbars

TTRUPD03 Fitting Instructions

