



TPUG16VK-6208

Alfa Romeo Junior (Exc. electric) 2025>, Citroen C3, C3 Aircross & Van (Inc. electric & hybrid) 2025>, C4 (Exc. electric) (Inc. hybrid) 2021> & C4X (Exc. electric) (Inc. hybrid) 2023>, DS3 Crossback (Exc. electric) (Inc. hybrid) 2020>, Fiat 600 (Exc. electric) (Inc. hybrid) 2025>, Jeep Avenger (Exc. electric) (Inc. hybrid) 2025>, Peugeot 2008 (Exc. electric) 2020>, Vauxhall Mokka (Exc. electric) 2020> & Vauxhall Frontera (Inc. electric & hybrid) 2024>

Item	Qty	Description	Item	Qty	Description	Torque Setting
A	1	TPUG16 Crossmember	F	6	M10 x 30 Bolts & S/P Washers	60 Nm
A1	2	Rear Panel Brackets	G	6	M10 x 35 Bolts & Nyloc Nuts	60 Nm
B	2	Side Arms	H	6	M8 x 45 (10.9) Bolts & S/P Washers	40 Nm
C	2	Angle Brackets	J	2	M12 x 22 Bolts & S/P Washers	100 Nm
D	1	6#08 Detachable Neck	K	2	M12 x 25 Bolts & S/P Washers	100 Nm
E	1	TPUG16VK L/H Flip Up Socket Plate	L	18	10 x 25 Flat Washers	
			M	6	8 x 25 H/D Flat Washers	
			N	4	12 x 25 Flat Washers	
			P	4	Small M10 Cage Nuts (Metal)	
			R	1	M8 x 30 Bolt & Nyloc Nut	
			S	3	8 x 20 Flat Washers	
			T	1	Neoprene Washer	

Bumper Removal:

- Open the rear tailgate, **2008**: remove one fixings either side of boot opening, remove the trim from the inside edge of each light cluster, this will enable you to access the bumper release clips (you may find this easier removing the complete light cluster, one fixing found inside the boot), **All Models**: remove three fixings from each wheel arch, unclip each wheel arch trim, remove six fixings from the bumper lower edge, carefully pull bumper tips sideways then carefully release from around each light cluster area, pull rearward to finally release the bumper from the vehicle body. Unplug any necessary wiring looms.

Towbar Installation:

- Locate the Towbar mounting points on the outside and lower face of each chassis (these will be covered with tape), clean the chassis faces then insert items **P** into the outside face mounting points.
- DS3 rear beam with weights ONLY**: Remove rear impact beam (and weights) and hand back to customer, these are not refitted with Towbar assembly.
Vauxhall Frontera: Remove the impact beam. This is not refitted with the Towbar assembly.
- All Models**: One side at a time, remove all fixings securing the rear impact beam to the vehicle, using item **H** with item **M** fix items **A1** to the rear panel sandwiching the rear impact beam. (Only fit to the outer upper point at this stage).
- Using item **H** with item **M** fix item **A** and items **A1** to the rear panel.
- Fix items **C** to the lower face of each chassis member using item **F** and item **L**.
- Fix items **B** to the outside face of each chassis member using item **F** and item **L**.
- Fix items **B** to items **C** and Item **A** using items **G** and items **L**.
- Using item **J** with item **N** and item **K** with item **N** fix item **D** and item **E** to item **A**.
- Assemble Socket plate (item **E**) using items **R**, **S** and **T**.
- Fully tighten all fixings ensuring the Towbar is rigid, square, and secure.
- Cut the rear bumper as shown below and refit.

Cage Nut Installation Method

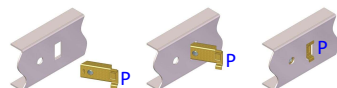

2008 Bumper Cut

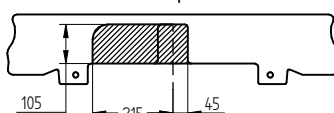

DS3 Bumper Cut

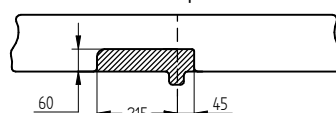

C4 Bumper Cut

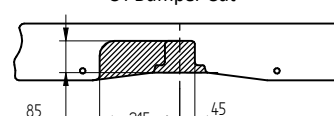

Frontera Bumper Cut

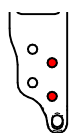
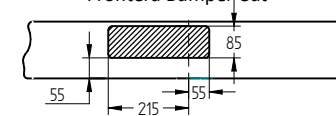

Neck Mounting Position

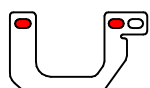

N/S Mounting Points



O/S Mounting Points

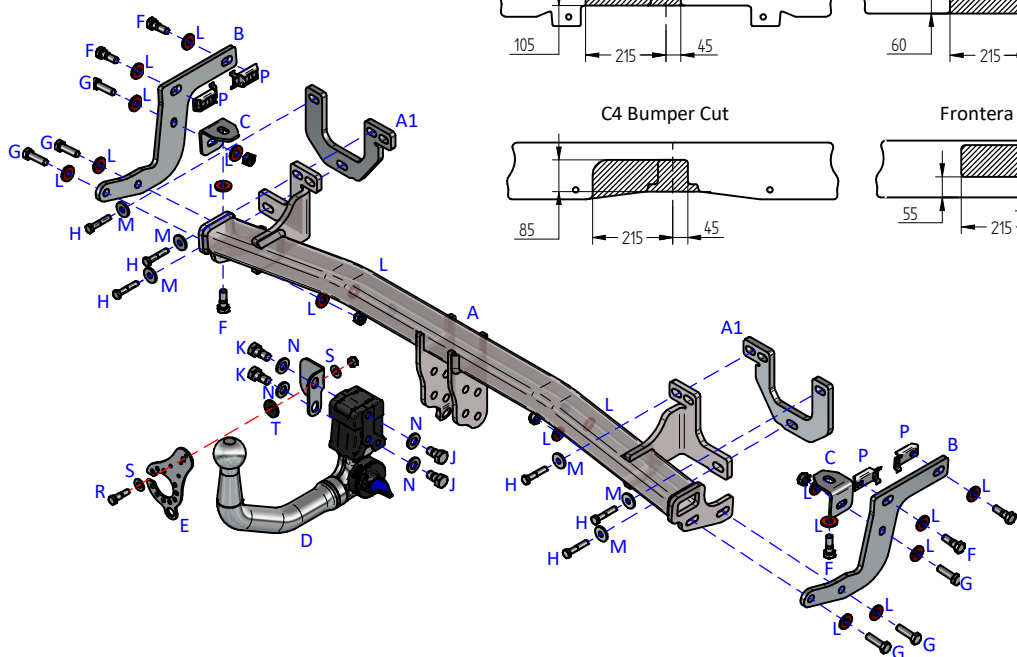

Notes:

- For Torque settings see the column next to each item in the list.
- Nose load limits and vehicle manufacturer's trailer / caravan weight limits must be observed.
- We recommend the use of PRO-TOW Couplings with all our products.