



# Tow-Trust Towbars

Important: Please read General Notes overleaf before fitting



Issue 10

## TFD8H FORD TRANSIT 2014>

Item	Qty	Description	Item	Qty	Description
A	1	Crossmember	D	2	M16 x 55 Bolts & Nyloc Nuts
B	2	Handed Side Arms	E	8	M12 x 100 Grade 10.9 Bolts, 4 Nyloc Nuts & 4 S/P Washers (110 Nm)
C	1	Slider Face Plate	F	4	M12 x 40 Grade 10.9 Bolts, 2 Nyloc Nuts & 2 S/P Washers
C1	2	Slider Pins & Clips	G	4	M12 x 40 Thread Rolling Bolts & 12 x 40 Flat Washer (80 Nm)
			H	4	12 x 30 Flat Washers
			J	16	12 x 25 Flat Washers
			K	4	M12 Bolt Caps

1. Lower the spare wheel.
2. Remove the existing Ford bolts from each chassis member and discard.
3. Using Item **H** as spacers loosely fix each side arm (Items **B**) to each chassis member using Items **E** and Item **J** (110Nm).
4. Using Item **G** fix items **B** to the vertical points. **NOTE:** These are untapped holes and the bolts supplied are thread rolling bolts designed to cut their own thread. (80Nm).
5. Using Item **F** with Item **J** bolt Item **A** between Items **B**.
6. Using Item **D** or Item **L** bolt your desired ball bracket (not supplied in this kit) to Item **C**.
7. Fully tighten all nuts and bolts ensuring the Towbar is rigid, square, and secure.

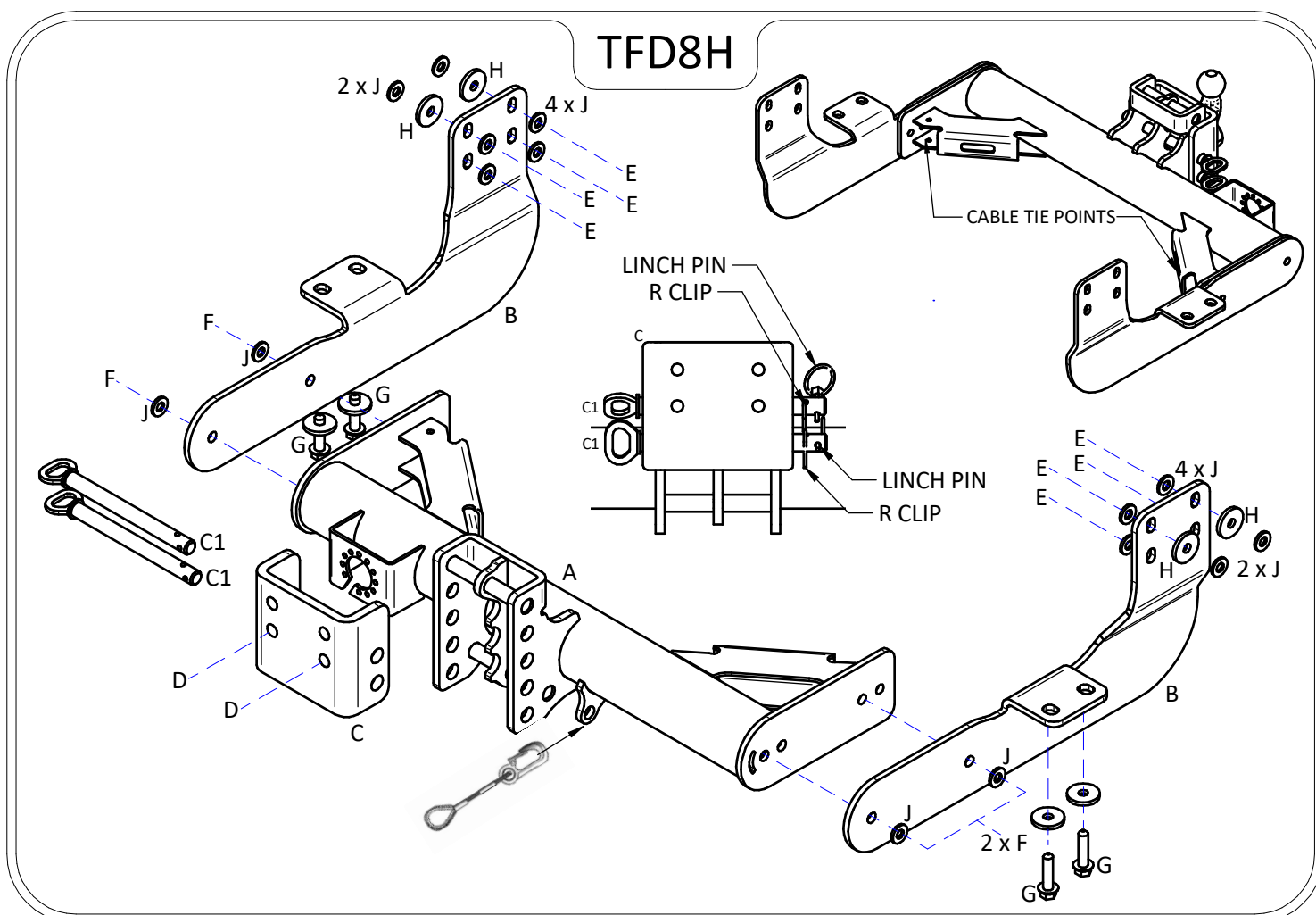

### Note:

1. Recommended Torque Setting for M12 Grade 10.9 -130 Nm. (For other Torque Settings see notes overleaf.)
2. Nose load limits and vehicle manufacturers trailer / caravan weight limits must be observed.