



Tow-Trust Towbars

Important: Please read General Notes overleaf before fitting



Issue 1

TDFS1 LOADHOPPER PICKUP & TIPPER 2011> AP011022

Item	Qty	Description	Item	Qty	Description
A	1	Crossmember	F	2	M16 x 50 Bolts Nuts & S/P Washers
B	2	Handed Side Arms	G	2	M12 x 100 Bolts & S/P Washers
C	1	Coupling Spacer	H	6	M12 x 40 Bolts, 4 Nuts & 6 S/P Washers
D	2	19 x 65 Long Spacer tube	J	10	12 x 25 Flat Washers
E	4	M12 Clamp Plates	K	2	12 x 40 Flat Washers

1. First locate the two existing holes on the lower rear face of each chassis member. (90mm centres).
2. Before marking out the side face for drilling, clean chassis members and ensure no under seal / grease is remaining.
3. Using the drilling diagram shown below mark out chassis members for drilling. Drill through both faces with a 14mm drill then open **one** face only to 20mm to allow the spacer tube (Item **D**) to be carefully inserted.
4. Once Item **D** is inserted loosely bolt Items **B** to each chassis member using Item **J** and Item **E**.
5. Using Item **H** with Item **K** bolt Items **B** to the lower face of each chassis member ensuring Item **E** is fitted inside.
6. Using Item **H** with Item **J** bolt Item **A** between Items **B**.
7. Using Item **F** and Item **C** bolt your desired ball bracket (Not Supplied in this kit) to Item **A**.

NOTE: ITEM C IS FITTED BEHIND THE BALL ON THE LOWER SETTING AND BEHIND THE FACE PLATE SANDWICHING THE TOWBAR ON THE TOP SETTING.

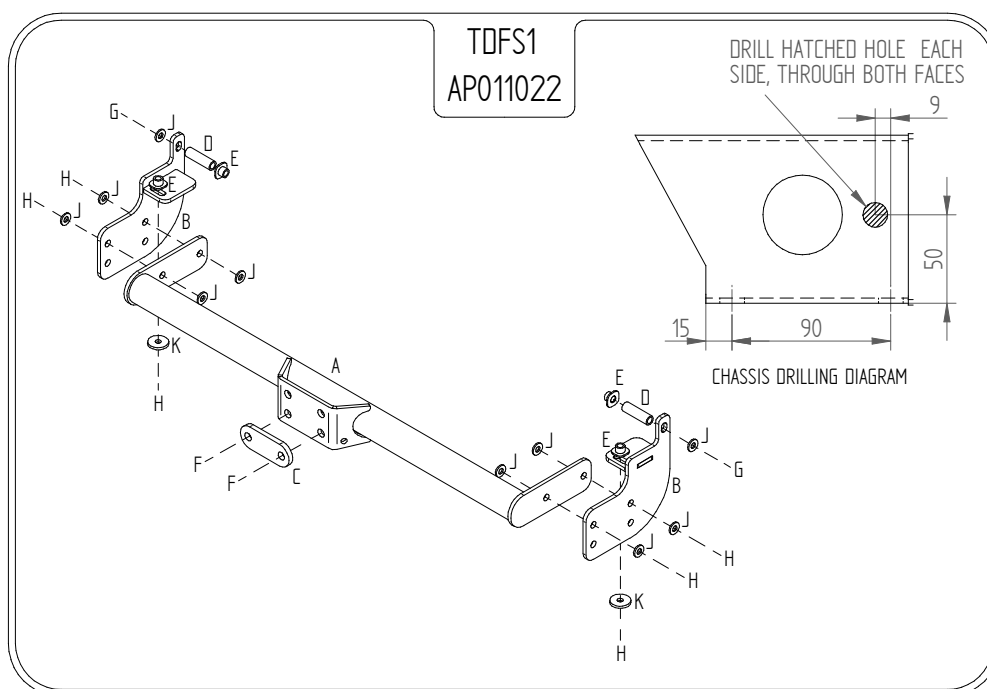

Note:

1. Recommended Torque Setting for M12 Grade 10.9 -139 Nm. (For other Torque Settings see notes overleaf.)
2. Nose load limits and vehicle manufacturers trailer / caravan weight limits must be observed.