

## TCN1-4x4 K9 L1 Chassis

Citroen Berlingo, Peugeot Partner 2008> Toyota Pro Ace City 2021> Vauxhall Combo 2018>

Item	Qty	Description	Item	Qty	Description
A	1	TCN1-4x4 Crossbar	D	2	M16 x 50 Bolts & Nyloc Nuts
B1	1	Left Hand Side Arm	E	6	M12 x 40 Bolts , 2 S/P Washers & 4 Nyloc Nuts
B2	1	Right Hand Side Arm	F	2	M12 x 85 Bolts (10.9) & Nyloc Nuts
C	1	Extension	G	4	M10 Nyloc Nuts
			H	4	10 x 25 Flat Washers
			J	12	12 x 25 Flat Washers
			K	2	12 x 30 Flat Washers

### Preparation For Installation

1. Remove the lower fixing from each side securing the bumper beam to the back panel.
2. Remove the two nuts and brackets from the existing studs on the bottom face of each chassis if present.  
(These are not refitted with the Towbar).

### Towbar Installation.

1. Fix Item **A** to the back panel using Items **E** with Items **K**.
2. Fix Items **B1** and **B2** to the chassis using Items **G** with Items **H**.
3. Fix Items **B1** and **B2** to Item **A** using Items **E** with Items **J**.
4. Fix Item **C** to Item **A** using Items **F** with Items **J**.
5. Using Items **D** fix your desired ball bracket and wiring plate (Not supplied in this kit) to Item **C**.
6. Fully tighten all fixings ensuring the Towbar is rigid, square and secure.

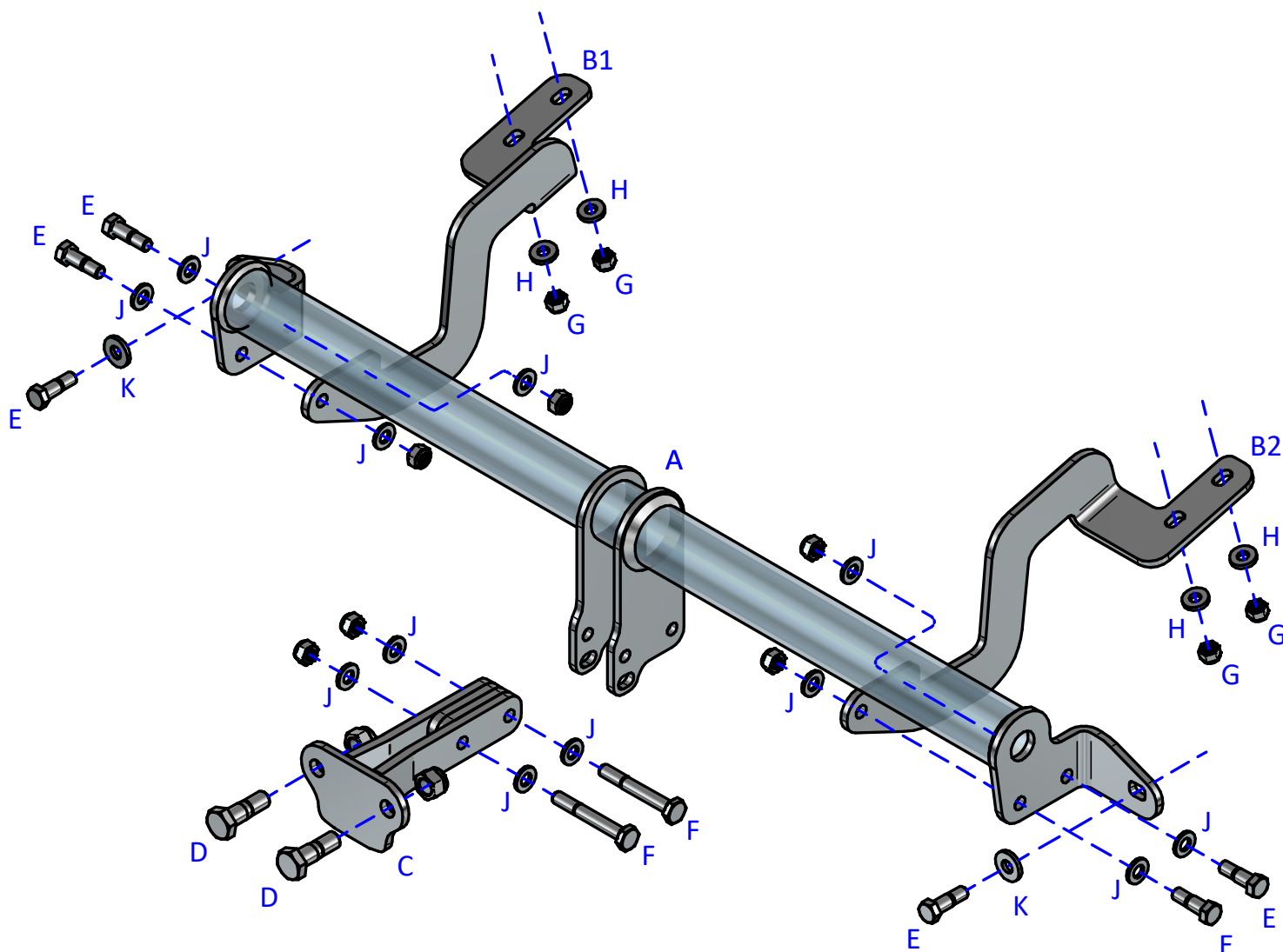

### Notes:

1. For Torque settings see general notes overleaf.
2. Nose load limits and vehicle manufacturer's trailer / caravan weight limits must be observed.